

Small Enclosures in North-east Wales

PROJECT REPORT



CPAT Report No 290

Small Enclosures in North-east Wales
PROJECT REPORT

N.W.Jones
February 1999

Report for Cadw: Welsh Historic Monuments

The Clwyd-Powys Archaeological Trust
7a Church Street, Welshpool, Powys, SY21 7DL
tel (01938) 553670, fax (01938) 552179
© CPAT 1999

CONTENTS

- 1 INTRODUCTION
- 2 PROJECT DESIGN
- 3 RECOMMENDATIONS FOR FURTHER WORK
- 4 ACKNOWLEDGEMENTS
- 5 BIBLIOGRAPHY

APPENDIX 1: Site gazetteer

1 INTRODUCTION

- 1.1 A report by John Manley (1990) highlighted the potential importance of a group of undated small enclosed settlements to our understanding of rural settlement in this region during the later prehistoric to early historic periods. The current project follows on from a rapid survey of small enclosures within the former county of Clwyd, undertaken during 1993/4 (Frost 1995). This identified over 80 sites where it was recommended that further work should be undertaken to enhance the SMR, with provisional recommendations also being made for scheduling 31 sites.
- 1.2 The current work has concentrated on those sites which were recommended for scheduling, with the objectives of improving our understanding of those sites, analysing the various morphological types and enhancing the protection and management.

2 PROJECT DESIGN

- 2.1 Following on from the previous work, the sites recommended for scheduling were reassessed, based initially on information extracted from the Regional Sites and Monuments Record. Of those sites where scheduling had previously been recommended, one site, Bron Fadog (PRN 102450), has since been scheduled (FI 173), while reassessment has led to five sites being withdrawn from the list: Plas-yr-escob PRN 19765; Plas Llanynys PRN 101818; Foelas PRN 101866; Blackhurst Cropmark A PRN 102662; Maes Mochnant Isaf cropmark PRN 101699. A reassessment of the remaining sites detailed in the previous report, including new field visits, led to a further three sites being added to the list of recommendations. The result was a list of 28 sites to be recommended for scheduling, the majority of which required further investigation in the form of aerial photographic rectification or ground survey. In two cases the Ordnance Survey record was deemed to be adequate for scheduling purposes. A full description of each site is given in Appendix 1.

Table 1: Sites recommended for scheduling

PRN	Name	Grid Ref.	Map	OS survey	AP plot	Ground survey
19736	Llangedwyn cropmark enclosure B	SJ19102395	SJ12SE		●	
19737	Llangedwyn cropmark enclosure A	SJ18922413	SJ12SE		●	
100678	Hafod Wen enclosure	SH98005016	SH95SE		●	
100700	Nant Tan-y-foel platform	SH98324993	SH94NE	●		
100701	Tyddyn Tudor enclosure A	SH97574958	SH94NE		●	
100789	Mynydd Rhyd Ddu enclosure	SJ05474775	SJ04NE	●		
101049	Hen Fache enclosure	SJ12392657	SJ12NW		●	
101454	Caer Drewyn hillslope enclosure	SJ09444498	SJ04SE		●	
101481	Pentrefelin enclosure and ring-ditch	SJ15602455	SJ12SE		●	
101632	Trevor Hall Lodge cropmark	SJ255418	SJ24SE		●	
101714	Blackhurst cropmark B	SJ463342	SJ43SE		●	
101715	Blackhurst cropmark C	SJ462341	SJ43SE		●	
101728	Cantaba Farm cropmark	SJ13155684	SJ15NW		●	
101729	Rhwylfa cropmark	SJ11066082	SJ16SW		●	
101730	Marian Ffrith enclosure	SJ07427792	SJ07NE			●
101756	Warren enclosure A	SH96157583	SH97NE			●
101757	Warren enclosure B	SH95917582	SH97NE			●
101773	Gwaenysgor enclosure	SJ07908154	SJ08SE		●	
101807	Wern Isaf enclosure	SJ22254230	SJ24SW		●	
101810	Caer Drewyn rectangular enclosure	SJ08984467	SJ04SE		●	
102156	Pen-y-Mynydd earthwork	SJ09527242	SJ07SE	●		
102653	Plasnewydd cropmark	SJ137555	SJ15NW		●	
102655	Llanynys cropmark	SJ102626	SJ16SW		●	
102658	Royton enclosure A	SJ369451	SJ34NE		●	
102659	Royton enclosure B	SJ369451	SJ34NE		●	
102661	Gamford House enclosure	SJ377575	SJ35NE		●	
102742	Fox Hall enclosure	SJ033673	SJ06NW			●
102934	Pennant Canol enclosure	SJ17625078	SJ15SE		●	

Aerial Photographic Rectification

- 2.2 For those sites where aerial photography provided the best record, a rectified plot was obtained using AutoCAD12, based on the largest scale Ordnance Survey map available, or where possible, Ordnance Survey digital data. The resulting plots were then converted to Mapinfo tables for integration into the SMR. Where more than one photograph could be rectified for a given site, the final plot was achieved as a best fit between the various sources. Selective photographs are reproduced in plates 1 to 6.
- 2.3 The aerial photographic and ground survey plots presented in this report adopt the standard SMR format to denote different types of feature as follows:
- Red - negative cropmark
 - Yellow - negative earthwork
 - Green - positive earthwork

Site Visits

- 2.4 All sites were revisited to complement the aerial photographic rectification and record the condition and landuse. Where possible information was also gathered relating to land ownership to aid with scheduling. Information from the site visits was used to further enhance the SMR.

Ground Survey

- 2.5 A detailed ground survey was considered necessary for four sites where no suitable aerial photographic record existed and which had not been recorded by the Ordnance Survey. The surveys were conducted during July and August 1998 using total station survey techniques. Each survey was related to points which could be identified on modern Ordnance Survey maps, although not to Ordnance Datum due to their remote locations. The resulting digital data was further enhanced and rectified to the OS grid using AutoCAD13 before being converted to Mapinfo tables for plotting and SMR enhancement.

3 RECOMMENDATIONS FOR FURTHER WORK

- 3.1 The previous rapid survey had identified a number of sites where further work was required (Frost 1995, Appendix 2), some of which has been completed as part of the current project. However, one of the key recommendations was for further aerial photography on a number of sites where the existing record was deemed to be insufficient, and to date no additional work has been undertaken. A number of sites have been omitted from the present recommendations for scheduling due to insufficient information either to define or accurately locate them, and it may be hoped that further aerial photography in the future will provide the necessary information.

4 ACKNOWLEDGEMENTS

- 4.1 CPAT is most grateful to the various landowners for the co-operation in allowing access for site visits and ground survey. The writer would also like to thank Wendy Owen for assisting with the ground survey and Les Bognar for undertaking many of the field visits.

5 BIBLIOGRAPHY

- Bowen, E.G., & Gresham, C.A., 1967. *History of Merioneth*, 1.
- Davies, E., 1929. *The Prehistoric and Roman Remains of Denbighshire*. Cardiff.
- Davies, E., 1949. *The Prehistoric and Roman Remains of Denbighshire*.
- Frost, P., 1995. *Clwyd Small Enclosures Rapid Survey*, CPAT Report 127.
- Guilbert, G., 1982. The Warren, *Archaeology in Wales* 22, 43.
- Manley, J., 1990. A Preliminary Survey of Some Undated Small Settlements in North-east Wales, *Archaeologia Cambrensis* 139, 21-55.
- Musson, C., 1994. *Wales from the Air, Patterns of Past and Present*. RCAHMMW.
- St. Joseph, J.S.K., 1961. Aerial Reconnaissance in Wales, *Antiquity* 35, 263-75.

Appendix 1: Gazetteer of Sites

LLANGEDWYN CROPMARK ENCLOSURE B**PRN 19736**

County	Powys	Community	Llangedwyn		
NGR	SJ18922413	Altitude	100	Period	Unknown
Form	Cropmark	Condition	Unknown	Threats	Ploughing

Description

Cropmark enclosure (Frost, P 1995, 112).

Poorly defined cropmark enclosure consisting of a N-S ditch c. 3.5m wide forming E side, with SE corner and part of S side also visible. Broad cropmark to NW may not be associated. Pit alignment PRN 101828 lies c. 55m to E.

Not visible at time of visit 20/5/98

References

CPAT AP 94-MB-363

CPAT Site visit 1998

LLANGEDWYN CROPMARK ENCLOSURE A**PRN 19737**

County	Powys	Community	Llangedwyn		
NGR	SJ19102395	Altitude	100	Period	Unknown
Form	Cropmark	Condition	Unknown	Threats	Ploughing

Description

Substantial single ditched enclosure, sub-rectangular with slightly rounded corners. c. 75m NE-SW by at least 110m NW-SE. Ditch up to 5m wide. E side not visible. Internal area c. 0.62ha.

Not visible at time of visit 20/5/98

References

CPAT AP 84-MB-363

CPAT Site visit 1998

SMALL ENCLOSURES IN NORTH-EAST WALES
Project 509

Llangedwyn Cropmark Enclosures A, B PRNs 19737, 19736. Scale 1:2,500. Map SJ12SE

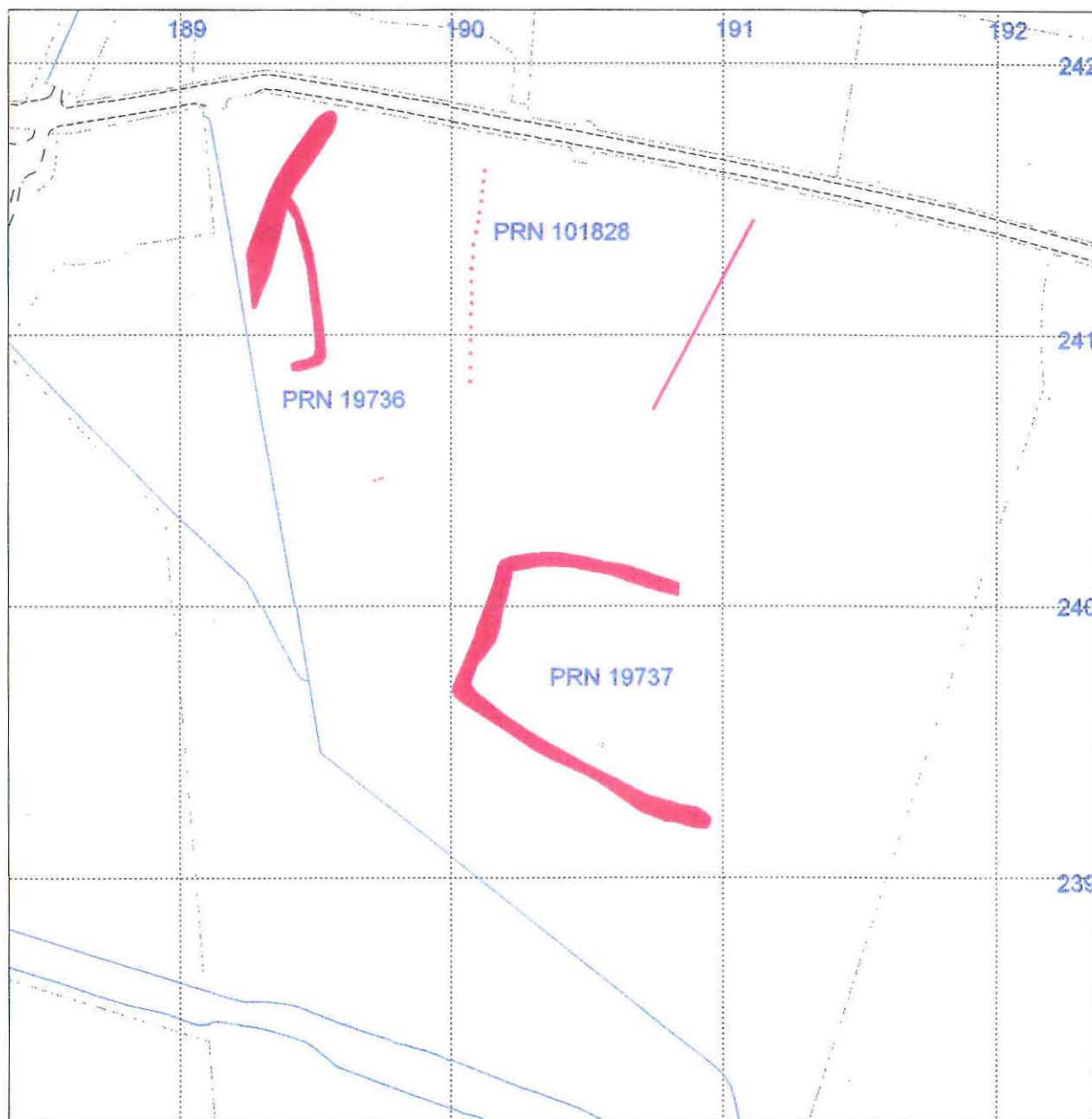

Based upon the Ordnance Survey mapping with the permission of the Controller of Her Majesty's Stationary Office
© Crown copyright. Unauthorised reproduction infringes Crown copyright and may lead to prosecution or civil proceedings.
Powys County Council licence number LA09016L, 1998

Archaeological data supplied by The Clwyd-Powys Archaeological Trust from the County Sites and Monuments Record
© CPAT, 1998

HAFOD WEN ENCLOSURE**PRN 100678****County** Conwy**Community** Llanfihangel Glyn Myfyr**NGR** SH98005016**Altitude** 351**Period** Prehistoric**Form** Earthwork**Condition** Damaged**Threats****Description**

The remains of a curvilinear enclosure marked by a ditch 4m wide and 0.2m deep with no trace of a bank. It is 36-42m in diameter. Davies notes that a prominent bank did once exist. U0985;

Site visit 30/10/98. The enclosure survives as described above and is best preserved to the SW. Possible slight counterscarp, but no sign of an inner bank. The full circuit is not visible, with the E side missing.

References

Davies. E., 1929, 230

OS record card, 1963, SH95SE 17

CCC Visit form, 1983

CPAT Air photo, 1984, 84-22-29 to 30

Manley 1990, 43, fig. 2

CPAT visit form 1994

OS 1:2500 survey

SMALL ENCLOSURES IN NORTH-EAST WALES
Project 509

Hafod Wen Enclosure, PRN 100678. Scale 1:2,500. Map SH95SE

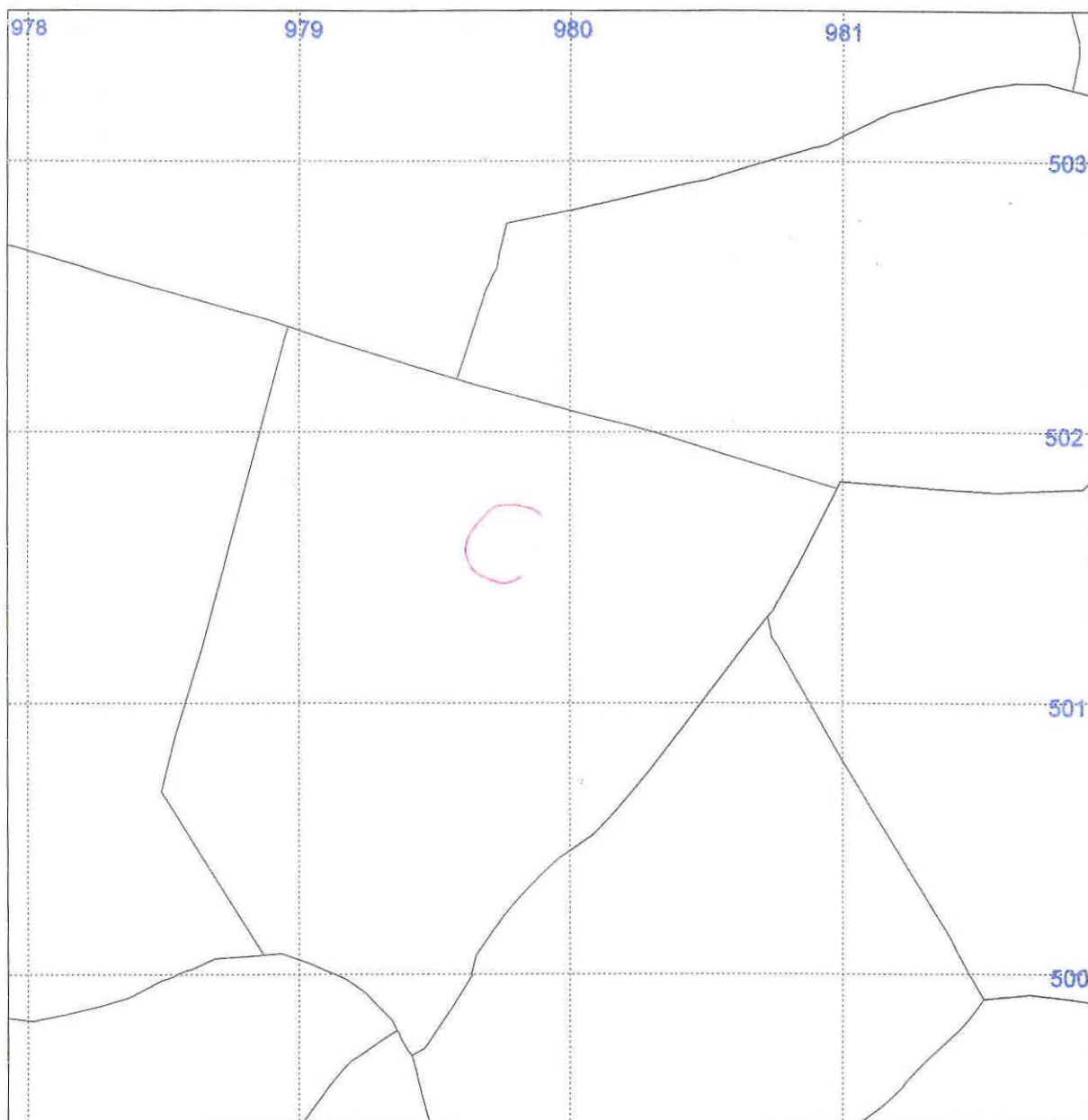

Based upon the Ordnance Survey mapping with the permission of the Controller of Her Majesty's Stationary Office
© Crown copyright. Unauthorised reproduction infringes Crown copyright and may lead to prosecution or civil proceedings.
Conway County Borough Council licence number L09000L 1998

Archaeological data supplied by The Clwyd-Powys Archaeological Trust from the County Sites and Monuments Record
© CPAT, 1998

NANT TAN-Y-FOEL PLATFORM**PRN 100700****County** Conwy**Community** Llanfihangel Glyn Myfyr**NGR** SH98324993**Altitude** 336**Period** Prehistoric**Form** Earthwork**Condition** Intact**Threats** None**Description**

A sub-circular platform scooped out of the hillside on the N and W, elsewhere surrounded by a bank 0.3m high and 5m wide. No trace of an entrance. Probably a hut platform c. 30m in diameter. U0985

References

Davies 1929, 230-1

OS Record card, 1963, SH 94 NE 11

CCC Visit form, 1983

CPAT Site visit 1998

Manley 1990, 43, fig. 2

OS 1:2,500 survey

SMALL ENCLOSURES IN NORTH-EAST WALES Project 509

Nant Tan-y-foel platform. PRN 100700. Scale 1:2,500. Map SH94NE

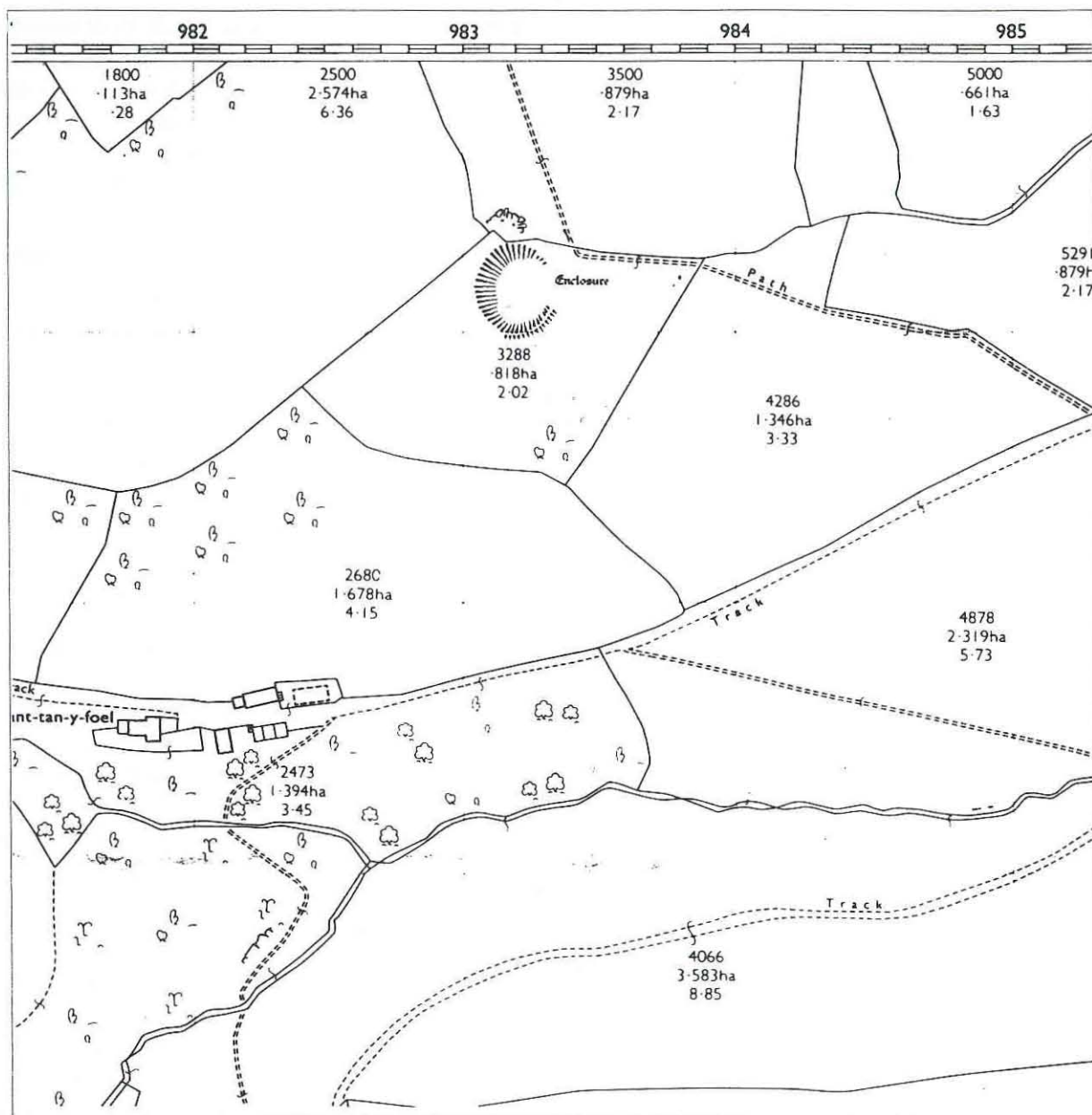

Reproduced from the Ordnance Survey's 1:2,500 map of 1973 with the permission mapping with the permission of the Controller of Her Majesty's Stationary Office. © Crown copyright.
Clwyd Powys Archaeological Trust licence number AL 50529A. 1988

Archaeological data supplied by The Clwyd-Powys Archaeological Trust from the County Sites and Monuments Record
© CPAT, 1998

TYDDYN TUDOR ENCLOSURE A**PRN 100701****County** Conwy**Community** Llanfihangel Glyn Myfyr**NGR** SH97574961**Altitude** 351**Period** Prehistoric**Form** Earthwork**Condition** Damaged**Threats** Ploughing**Description**

Circular enclosure roughly 50m in diameter. Bank 0.3m high. Possible entrance to E. Curvilinear platform appends to W. Sited on level ground. Note CAR 655 to NW. U0985;

Sub-circular enclosure c. 50m diameter with probable entrance to SE. Internal area c. 0.21ha. Outer bank to S and W with S entrance, c. 12m from main enclosure. The outer bank terminates at the NW with a sub-square enclosed area c. 15m x 15m. The E side is damaged by a track. Associated field system PRN 13349 most obvious to W, but also extending to S and N.

References

Davies 1929, 231
 OS Record card, 1963, SH 94 NE 12
 CCC Site visit form
 CPAT AP, 1987, 87-MB-1010 and 1011
 Manley 1990, 43, pl. 11 and fig. 2
 CPAT Site visit form, 1994
 OS 1:2,500 survey
 CPAT Site visit 1998

TYDDYN TUDOR FIELD SYSTEM**PRN 13349****County** Conwy**Community** Llanfihangel Glyn Myfyr**NGR** SH97454955**Altitude** 350**Period** Prehistoric**Form** Earthwork**Condition** Damaged**Threats****Description**

Field system consists of linear banks radiating from enclosure PRN 100701, two roughly parallel to the W, one to the N and one to the S. Continuation of field banks in adjacent field to W.

References

OS Record card, 1963, SH 94 NE 12
 CCC Site visit form
 CPAT AP, 1987, 87-MB-1010 and 1011
 Manley 1990, 43, pl. 11 and fig. 2
 CPAT Site visit form, 1994
 CPAT Site visit 1998

SMALL ENCLOSURES IN NORTH-EAST WALES
Project 509

Tyddyn Tudor Enclosure A PRN 100701. Scale 1:2,500. Map SH94NE

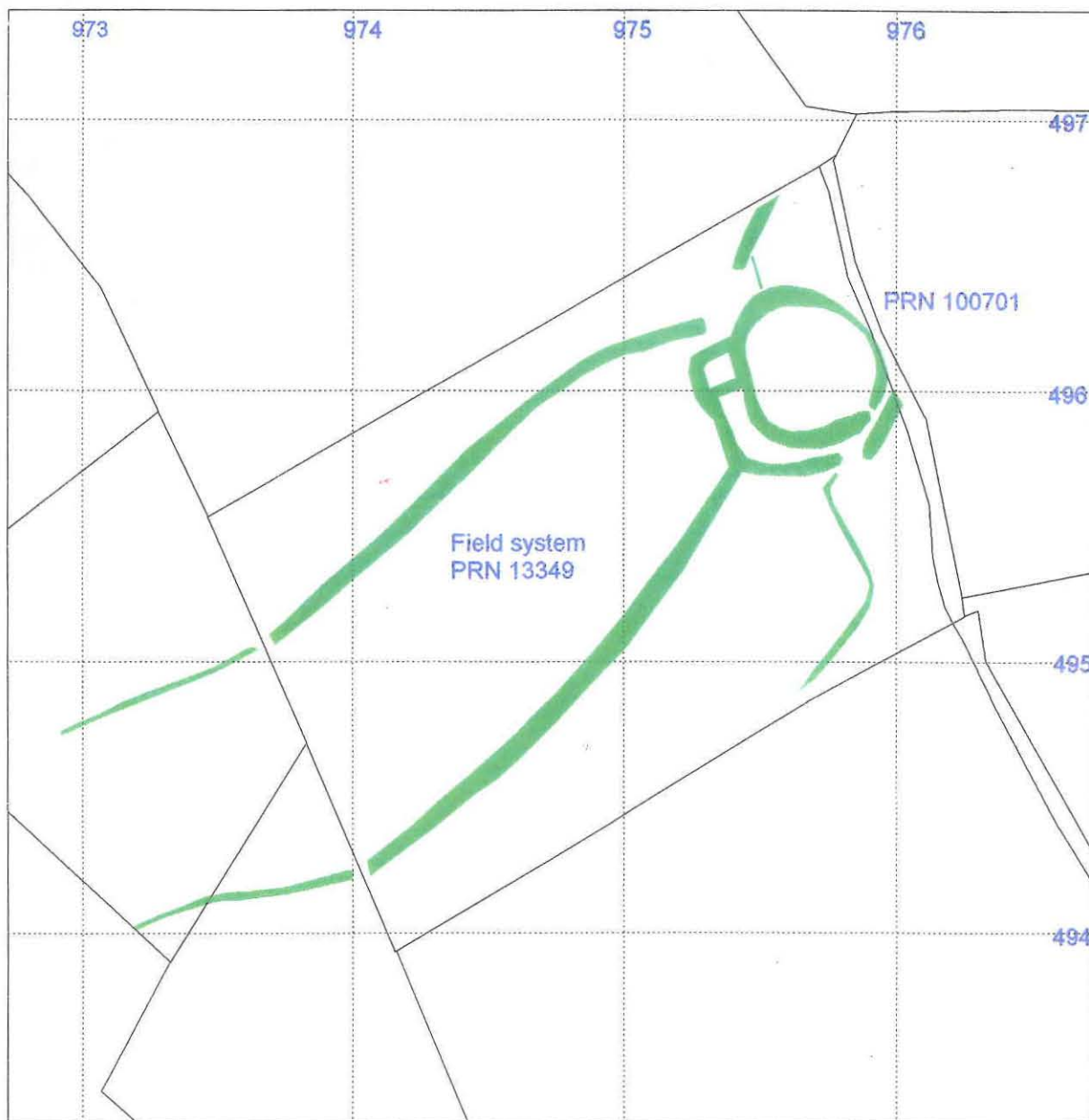

Based upon the Ordnance Survey mapping with the permission of the Controller of Her Majesty's Stationary Office
© Crown copyright. Unauthorised reproduction infringes Crown copyright and may lead to prosecution or civil proceedings.
Redrawn from OS 1:10,000 SH94NE. Clwyd Powys Archaeological Trust licence No AL 50529A

Archaeological data supplied by The Clwyd-Powys Archaeological Trust from the County Sites and Monuments Record
© CPAT, 1998

MYNYDD RHYD DDU ENCLOSURE**PRN 100789****County** Denbighshire**Community** Bettws Gwerfil Goch**NGR** SJ05474775**Altitude** 270**Period** Iron Age**Form** Earthwork**Condition** Damaged**Threats** None**Description**

An oval enclosure on the level summit of Mynydd Rhyd Ddu. The surrounding bank is 0.8m high at most. Made up largely of stone. In poor condition to SW of field wall. Possible entrance to N not noted in 1983. U0885;

Oval enclosure as depicted by OS. Bank roughly 0.75m to 1.0m wide and 0.5m high. Interior is higher than perimeter. LB 19/5/98

References

RCAHMW 1921, 35

Bowen and Gresham 1967, 170-2

OS Record card, 1971, SJ 04 NE 1

CCC Site visit form, 1983

CCC ground photo, 1983

CPAT AP 1987, 87-MB-630

Manley 1990, 44, fig. 2

OS 1:2,500 survey

CPAT Site visit 1998

SMALL ENCLOSURES IN NORTH-EAST WALES
Project 509

Mynydd Rhyd Ddu enclosure. PRN 100789. Scale 1:2,500. Map SJ04NE

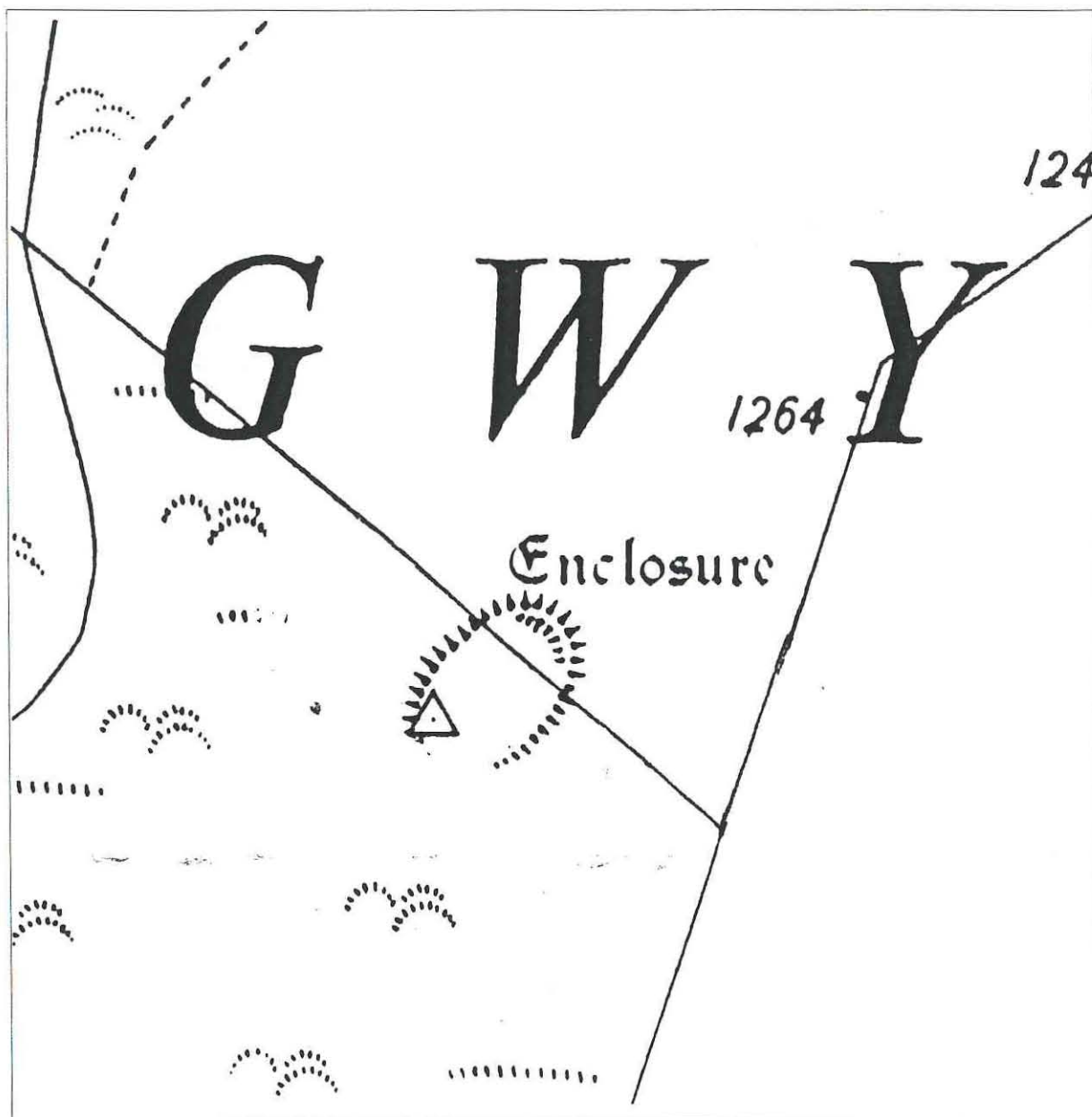

Reproduced from the Ordnance Survey's 1:10, 560 map of 1973 with the permission mapping with the permission of the Controller of Her Majesty's Stationary Office. © Crown copyright.
Clwyd Powys Archaeological Trust licence number AL 50529A. 1988

Archaeological data supplied by The Clwyd-Powys Archaeological Trust from the County Sites and Monuments Record
© CPAT, 1998

HEN FACHE ENCLOSURE**PRN 101049****County** Powys**Community** Llanrhaeadr-ym-Mochnant**NGR** SJ12392658**Altitude** 225**Period** Iron Age ?**Form** Cropmark**Condition** Unknown**Threats** Ploughing**Description**

Cropmark of small oval enclosure marked by single line. St. Joseph suggests Iron Age date. Situated on flat ground with good views to S and W. U0885;

AP plot as part of project 509 1998. Single narrow ditch defines sub-circular enclosure c. 36m diameter, with an internal area of c. 0.1ha. SW corner not clearly visible, but may include the entrance.

Not visible at time of visit 20/5/98.

References

St. Joseph 1961, 268
OS Record card, 1974, SJ 12 NW 5
CPAT AP, 1984, 84-MB-352
CPAT AP, 1986, 86-14-2 and 3, 86-MB-788 and 789
CUCAP, ED042-3
Manley 1990, 44, fig. 2
CCC Site visit form, 1994
CPAT Site visit form, 1994
CPAT Site visit 1998

SMALL ENCLOSURES IN NORTH-EAST WALES
Project 509

Hen Fache Enclosure PRN 101049. Scale 1:2,500. Map SJ12NW

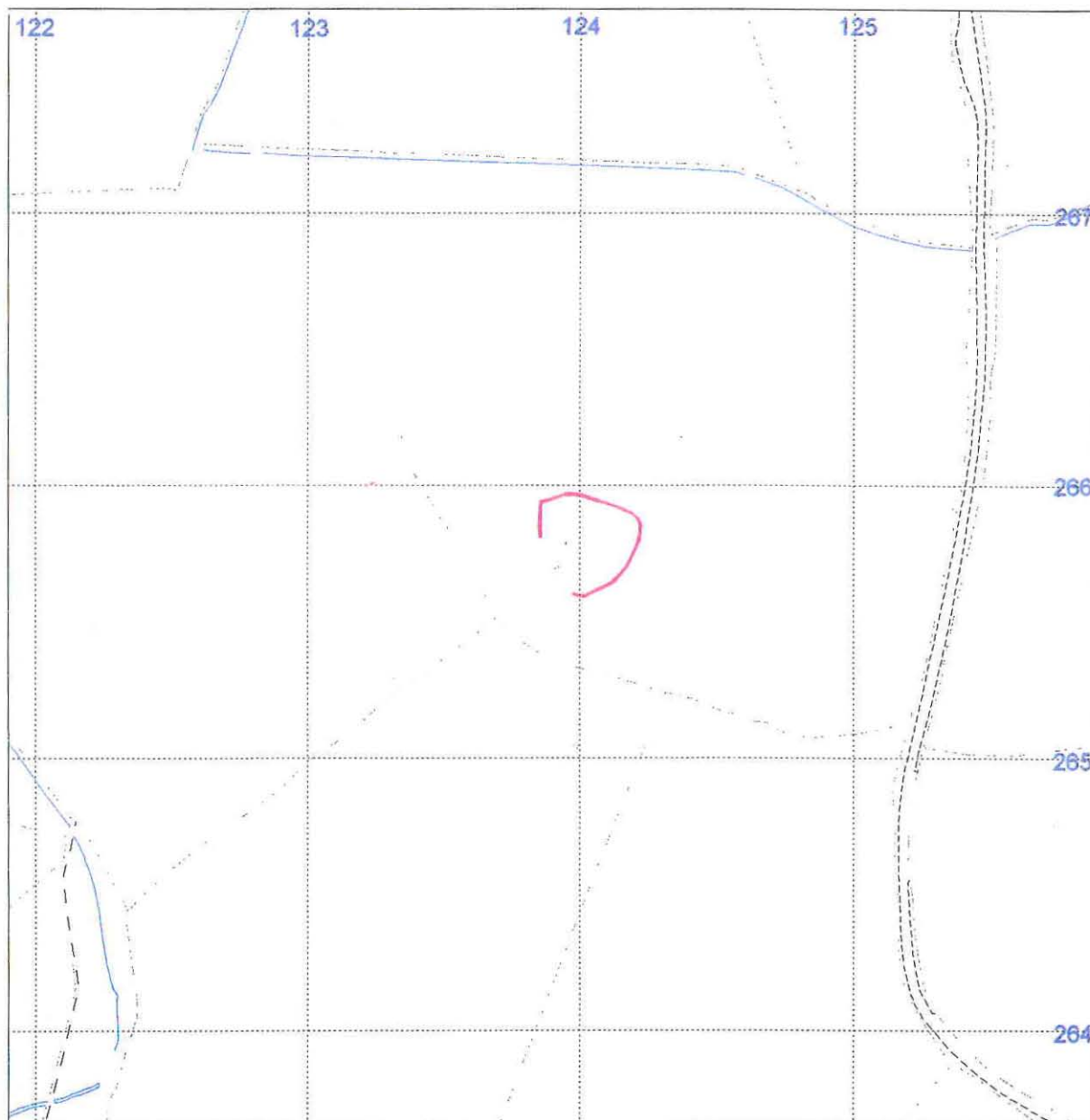

Based upon the Ordnance Survey mapping with the permission of the Controller of Her Majesty's Stationary Office
© Crown copyright. Unauthorised reproduction infringes Crown copyright and may lead to prosecution or civil proceedings.
Powys County Council licence number LA09016L, 1998

Archaeological data supplied by The Clwyd-Powys Archaeological Trust from the County Sites and Monuments Record
© CPAT, 1998

CAER DREWYN HILLSLOPE ENCLOSURE**PRN 101454**

County	Denbighshire	Community	Corwen		
NGR	SJ09444498	Altitude	236	Period	Iron Age
Form	Earthwork	Condition	Damaged	Threats	None

Description

Multivallate enclosure 90 x 60m, situated on N facing slope dominated by high ground to S. Oval in shape with inner and outer series of bank and ditch. Inner bank 2m high on S side, entrance to N. N0180;

AP plot during project 509 1998. Main enclosure c. 70-65m with entrance at NW corner. Internal area c. 0.35ha. Single outer ditch to N and E and a series of possibly three external ditches to W.

References

CCC Site visit form, 1984
CPAT AP, 1983, 83-24-18
CPAT AP, 1984, 84-15-16 and 17
CPAT AP, 1985, 85-2-18 and 19
CPAT AP, 1986, 86-5-10, 86-MB-114 and 115
CUCAP AWP39
RCAHMMW APs 915005-13, 93510057-8
Manley 1990, 45, fig. 2
Musson 1994, 106
CPAT Site visit 1998

CAER DREWYN RECTANGULAR ENCLOSURE**PRN 101810**

County	Denbighshire	Community	Corwen		
NGR	SJ09004473	Altitude	260	Period	Roman ?
Form	Earthwork	Condition	Damaged	Threats	None

Description

Rectangular enclosure 55-45m marked by bank 7m wide and 0.5m high, ditch 4m wide and 0.4m deep. Has possible entrance on E side. Situated on N facing slope with high ground to S. S and W sides somewhat denuded. N1284;

AP plot during project 509 1998. The area to the S and E has a series of banks of possibly associated field system PRN 13345. A possible rectangular platform PRN 13344 lies immediately to S.

References

CCC Site visit form, 1984
CPAT Site visit form, 1994
CPAT AP, 1984, 84-15-18
CPAT AP, 1985, 85-2-16 and 17
CPAT AP, 1985, 85-4-35 and 36
CPAT AP, 1985, 85-6-21
CPAT AP, 1986, 86-5-7 and 8
CPAT AP, 1986, 86-MB-116 and 118

CPAT AP, 1987, 87-MB-993
 CUCAP AWP 39
 RCAHMW AP 93510057/8
 Manley 1990, 49, fig. 2
 CPAT Site visit 1998

CAER DREWYN PLATFORM		PRN	13344
County	Denbighshire	Community	Corwen
NGR	SJ09024466	Altitude	260
		Period	Unknown
Form	Earthwork	Condition	Damaged
		Threats	

Description

Rectangular feature visible clearly from aerial photographs, but less so from the ground. The ground slopes to the N with Caer Drewyn Rectangular enclosure PRN 101810 immediately to the N. The feature is slightly terraced into the slope at the rear and built out against it at the front, measuring 55 x 20m.

Possibly associated with nearby enclosure and also with field system PRN 13345.

References

CUCAP AWP 39
 CPAT 86-5-8
 CPAT Site visit 1998

CAER DREWYN FIELD SYSTEM		PRN	13345
County	Denbighshire	Community	Corwen
NGR	SJ092448	Altitude	260
		Period	Prehistoric
Form	Earthwork	Condition	Damaged
		Threats	None

Description

A series of linear banks visible clearly from aerial photographs, but less so on the ground. Possible association with nearby enclosures PRNs 101454 and 101810.

References

CUCAP AWP 39
 CPAT Site visit 1998

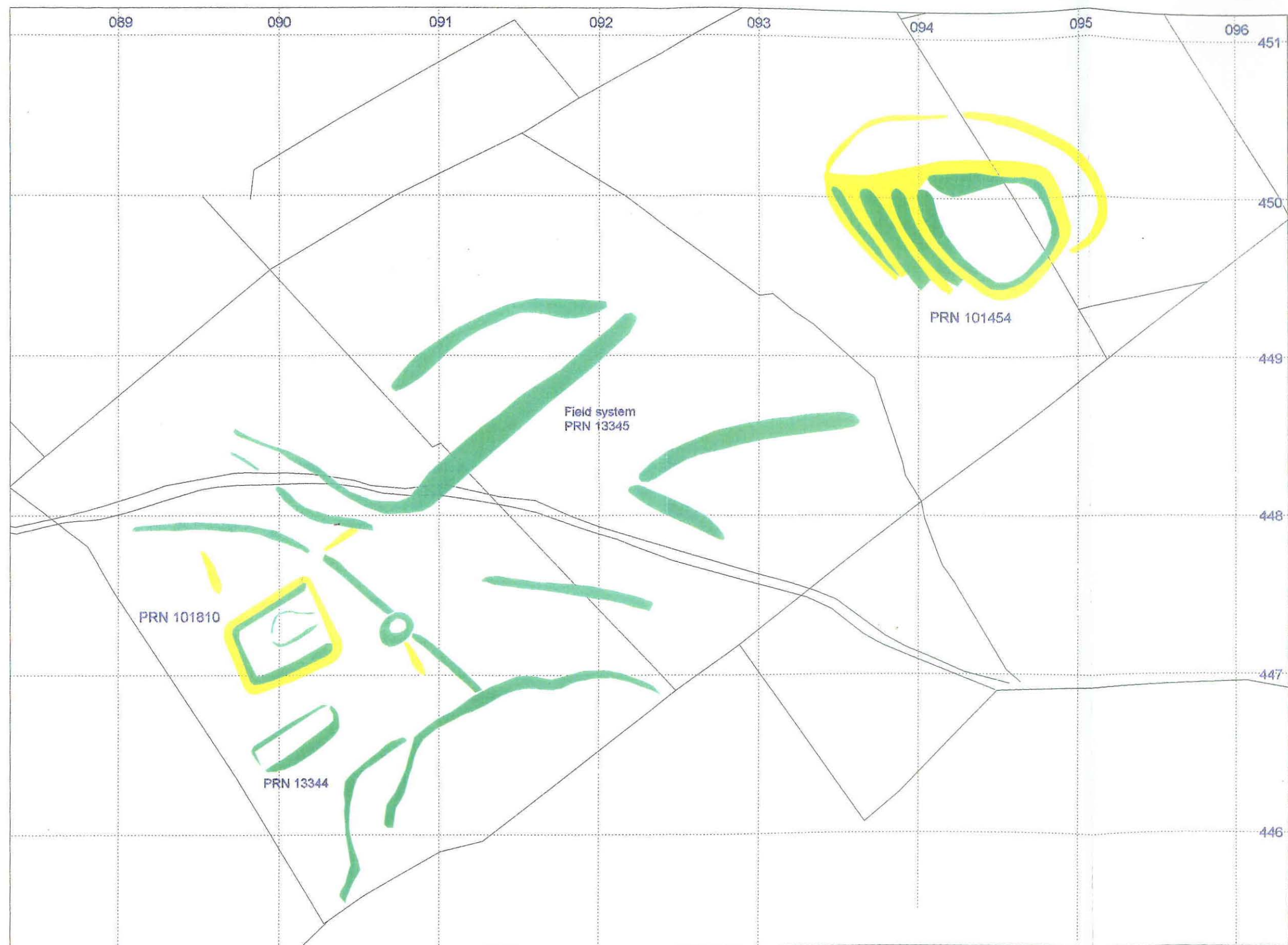

PENTREFELIN RING DITCH**PRN 101483****County** Powys**Community** Llanrhaeadr-ym-mochnant**NGR** SJ15692456**Altitude** 110**Period** Bronze Age**Form** Cropmark**Condition** Damaged**Threats** Ploughing**Description**

Roughly circular cropmark c. 35m in diameter visible in NE corner of enclosure PRN 101481. Cropmark visible in field to E may be NE corner of enclosure rather than a continuation of the ring ditch, although this is not clear.

The site is mistakenly labelled in Gibson 1998.

References

CPAT AP, 1977, 77-15-1 to 5, 77-61-1 to 2
 CPAT AP, 1979, 79-19-1 to 3, 79-59-33, 79-CT-15 to 17
 CPAT AP, 1983, 83-19-35, 83-C-142 and 430
 CPAT AP 1984, 84-MB-356
 CPAT Site visit 1998

PENTREFELIN ENCLOSURE**PRN 101482****County** Powys**Community** Llanrhaeadr-ym-Mochnant**NGR** SJ15602455**Altitude** 110**Period** Prehistoric ?**Form** Cropmark**Condition** Near destroyed**Threats****Description**

Double ditched rectilinear enclosure with ditches widely spaced. Sited on flat ground overlooking the floodplain to the south. U0885;

AP plot during project 509 1998. Inner ditched circuit defines an area c. 80m E-W by 70m N-S with possible gap/entrance along S side towards SW corner. Outer ditch c. 25m from inner, only W and N sides clearly visible but NE corner and E side suggested on 84-MB-356. Possible ring ditch 101483 in NE corner extends into field to E and may have been confused with NE corner of enclosure. A second, smaller enclosure PRN 106069 adjoins the eastern side.

Not visible at time of visit 20/5/98.

References

CPAT AP, 1977, 77-15-1 to 5, 77-61-1 to 2
 CPAT AP, 1979, 79-19-1 to 3, 79-59-33, 79-CT-15 to 17
 CPAT AP, 1983, 83-19-35, 83-C-142 and 430
 CPAT AP 1984, 84-MB-356
 CPAT Site visit 1998

PENTREFELIN ENCLOSURE 2**PRN 106069****County** Powys**Community** Llanrhaeadr-ym-Mochnant**NGR** SJ15602450**Altitude** 0**Period** Unknown**Form** Cropmark**Condition** Unknown**Threats****Description**

Sub-rectangular cropmark visible on CPAT aerial photographs 79/19/2 and 3 adjoining Pentrefelin enclosure PRN 101482 on the east side.

AP plot as part of Project 509, c. 12 x 8m.

References

SMALL ENCLOSURES IN NORTH-EAST WALES Project 509

Pentrefelin Enclosures PRN 101482, 106069 and ring ditch PRN 101483.
Scale 1:2,500. Map SJ12SE

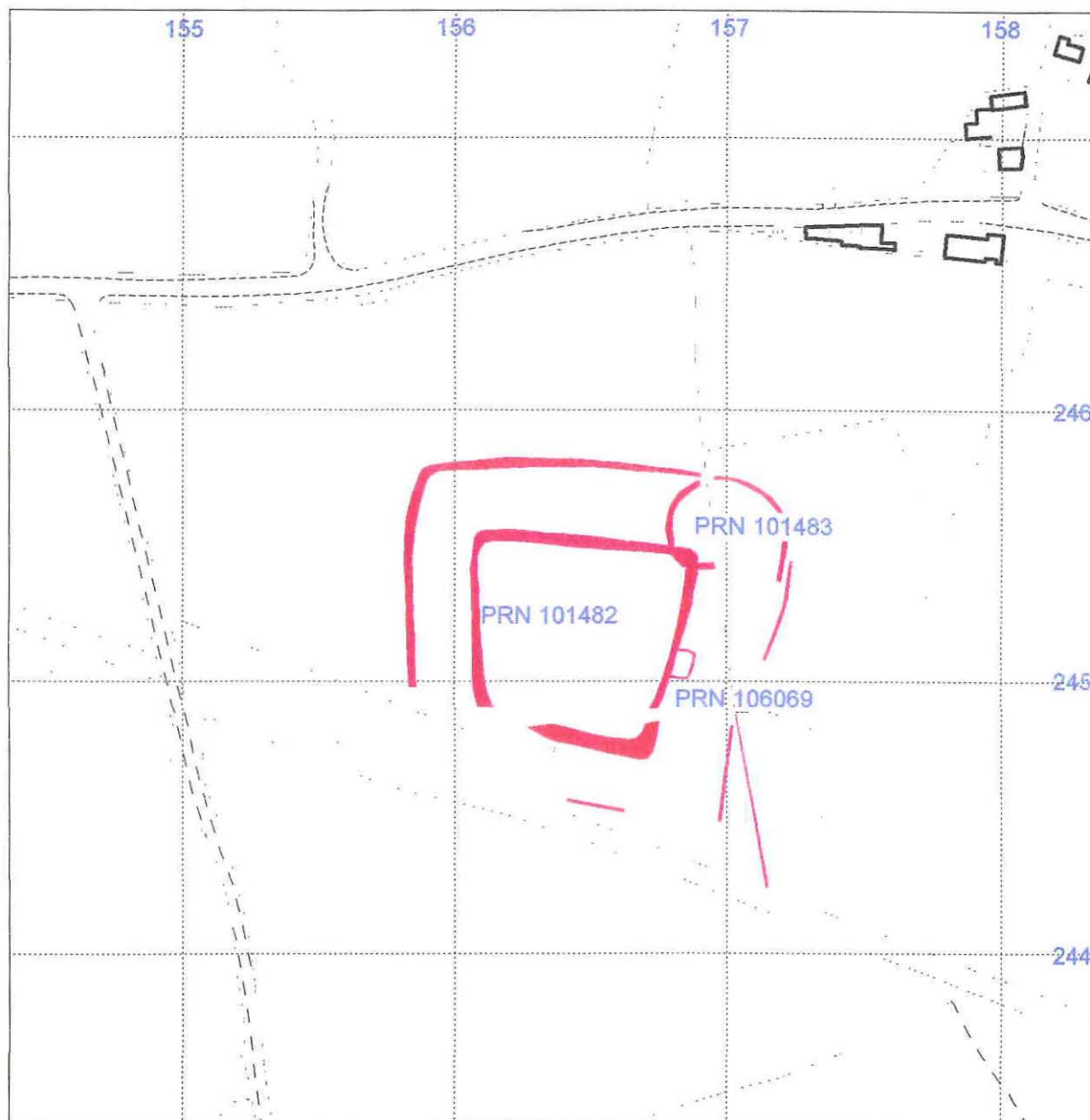

Based upon the Ordnance Survey mapping with the permission of the Controller of Her Majesty's Stationary Office
© Crown copyright. Unauthorised reproduction infringes Crown copyright and may lead to prosecution or civil proceedings.
Powys County Council licence number LA09016L, 1998

Archaeological data supplied by The Clwyd-Powys Archaeological Trust from the County Sites and Monuments Record
© CPAT, 1998

TREVOR HALL LODGE CROPMARK**PRN 101632****County** Denbighshire **Community** Llangollen Rural**NGR** SJ25534185 **Altitude** 80 **Period** Iron Age**Form** Cropmark **Condition** Unknown **Threats** Ploughing**Description**

A large roughly oval cropmark presumably representing a wide ditch with entrance to S. Sited on high point of valley floor. Bisected by railway. U0985;

AP plot during project 509 1998. To S of railway a single well-defined curving ditch is visible with possible entrance to SE. To the north, a single curving ditch is visible, but becoming less well defined to NE. Overall diameter c.70m with internal area c. 0.43ha. Nothing visible on the ground at time of site visit 19/5/98.

References

CCC Site visit form, 1984
CUCAP, 1975, BUC 024
CPAT Site visit form, 1994
Manley 1990, 46, fig. 2
CPAT Site visit 1998

SMALL ENCLOSURES IN NORTH-EAST WALES
Project 509

Trevor Hall Lodge Cropmark. PRN 101632. Scale 1:2,500. Map SJ24SE

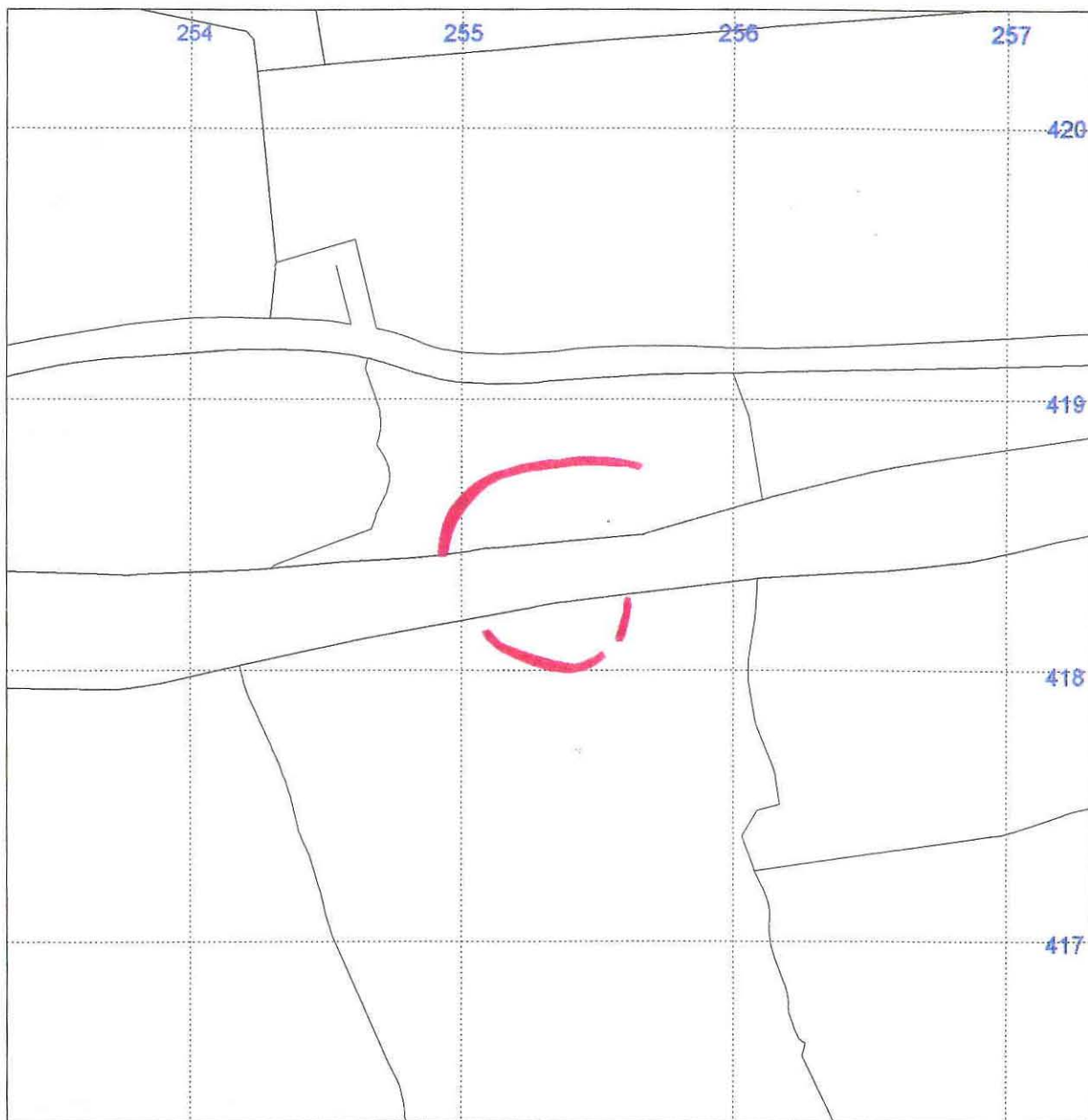

Based upon the Ordnance Survey mapping with the permission of the Controller of Her Majesty's Stationary Office
© Crown copyright. Unauthorised reproduction infringes Crown copyright and may lead to prosecution or civil proceedings.
Denbighshire County Council licence number LA09008L. 1998

Archaeological data supplied by The Clwyd-Powys Archaeological Trust from the County Sites and Monuments Record
© CPAT, 1998

BLACKHURST CROPMARK B**PRN 101714****County** Wrexham**Community** Maelor South**NGR** SJ46333428**Altitude** 95**Period** Roman**Form** Cropmark**Condition** Unknown**Threats** Ploughing**Description**

Sub-rectangular cropmark, its southern edge being confused by E-W hedge. Its angularity when compared to 101715 possibly suggests a later date. Nothing visible on the ground. CAR1697 to SW. CAR4212 to N. U0985;

AP plot during project 509 1998. Single ditched enclosure c. 45m x 45m. Nothing visible at time of visit 20/5/98, field under barley.

References

CCC Site visit form, 1984
CPAT Site visit form, 1994
CUCAP CKS 100-101, CHV 46
Manley 1990, 46, fig. 2
CPAT Site visit 1998

BLACKHURST CROPMARK C**PRN 101715****County** Wrexham**Community** Maelor South**NGR** SJ46243415**Altitude** 95**Period** Roman**Form** Cropmark**Condition** Unknown**Threats** Ploughing**Description**

Complex cropmark adjacent to N-S road. Consists of an outer enclosure mark with a smaller rectangular mark inside it in the NE corner. Shape not unlike a mansio. Nothing visible on ground. CAR1696 to NE CAR4212 to SE;

AP plot during project 509 1998. Inner enclosure defined by single ditch c. 55 x 40m. Outer ditches slightly eccentric with rounded corners, c. 15m from inner to S, E and N, but c.40 away to W. No obvious entrance. Nothing visible at time of visit 20/5/98, field under barley.

References

CCC Site visit form, 1981
CCC Site visit form, 1983
CCC ground photo, 1984
CPAT Site visit form, 1994
CPAT AP, 1979, 79-22-3, 79-CX-15 to 16
CPAT AP, 1989, 89-C-189
Manley 1990, 46, fig. 2
CPAT Site visit 1998

SMALL ENCLOSURES IN NORTH-EAST WALES
Project 509

Blackhurst Cropmarks. Scale 1:2,500. Map SJ43SE



Based upon the Ordnance Survey mapping with the permission of the Controller of Her Majesty's Stationary Office
© Crown copyright. Unauthorised reproduction infringes Crown copyright and may lead to prosecution or civil proceedings.
Redrawn from OS 1:10,000 SJ43SNE. Clwyd Powys Archaeological Trust licence number AL 50529A

Archaeological data supplied by The Clwyd-Powys Archaeological Trust from the County Sites and Monuments Record
© CPAT, 1998

CANTABA FARM CROPMARK**PRN 101728****County** Denbighshire**Community** Ruthin**NGR** SJ13205684**Altitude** 74**Period** Prehistoric**Form** Cropmark**Condition** Unknown**Threats** Ploughing**Description**

Rectangular cropmark enclosure visible on 1983 AP (Musson). Possible entrance on W side. Sited on flat ground;

AP plot during project 509 1998. Subrectangular cropmark enclosure c. 52m E-W with E side c. 60m and W side c. 48m. A second, outer ditch visible to E and SE roughly 12m outside main enclosure. Nothing visible at time of visit 15/5/98.

References

CCC Site visit form, 1984

CPAT AP 1983, 83-10-10 to 16

CPAT AP 1983, 83-C-233 to 234

CPAT AP 1984, 84-MB-277

CPAT Site visit form 1984

CPAT Site visit form 1994

Manley 1990, 46, fig. 2

CPAT Site visit 1998

CPAT Report No 290

SMALL ENCLOSURES IN NORTH-EAST WALES
Project 509

Cantaba Farm Cropmark. PRN 101728. Scale 1:2,500. Map SJ15NW

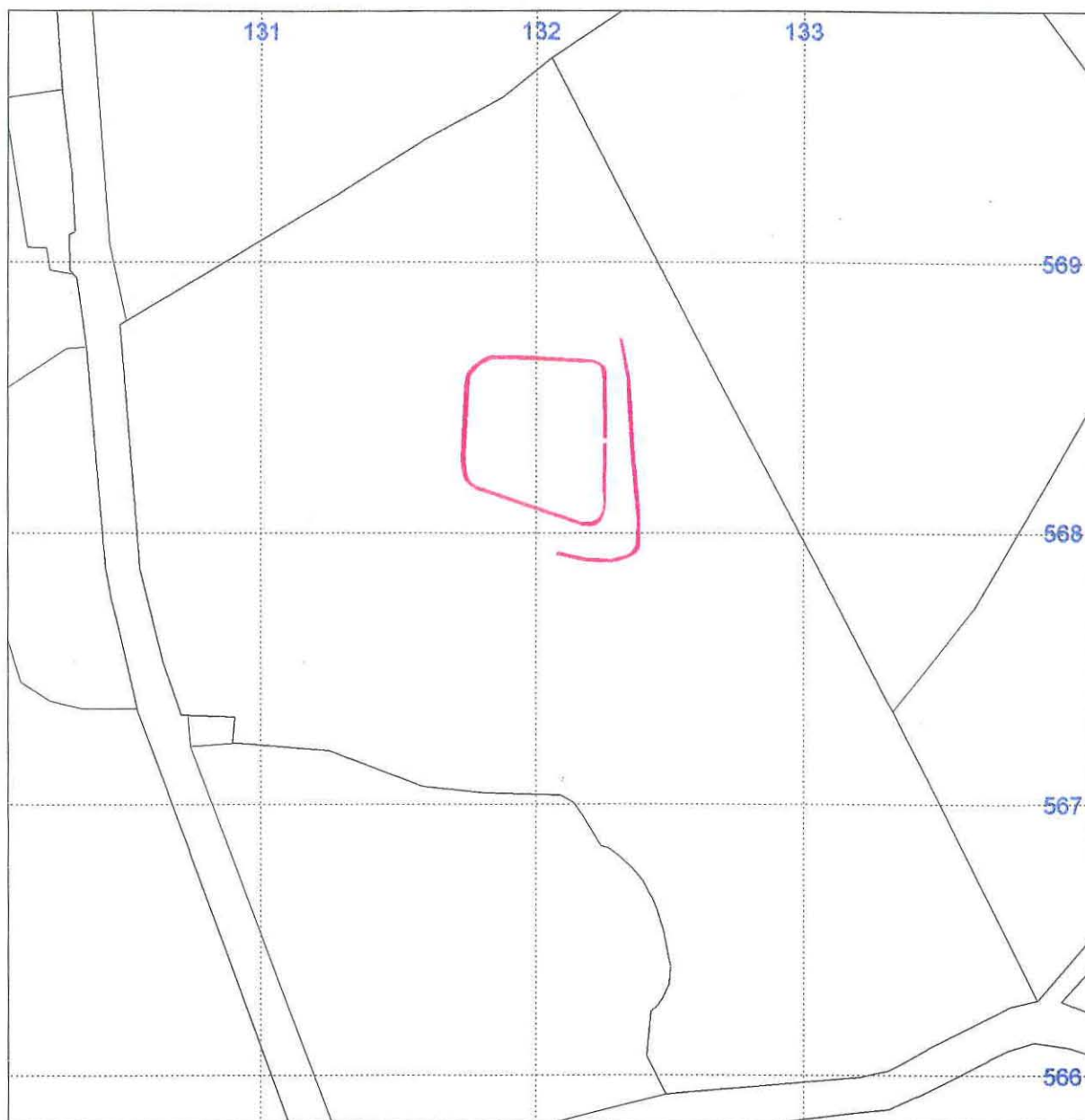

Based upon the Ordnance Survey mapping with the permission of the Controller of Her Majesty's Stationary Office
© Crown copyright. Unauthorised reproduction infringes Crown copyright and may lead to prosecution or civil proceedings.
Denbighshire County Council licence number LA09008L. 1988

Archaeological data supplied by The Clwyd-Powys Archaeological Trust from the County Sites and Monuments Record
© CPAT, 1998

RHWYLFA CROPMARK**PRN 101729****County** Denbighshire**Community** Llanynys**NGR** SJ11066079**Altitude** 50**Period** Roman ?**Form** Cropmark**Condition** Unknown**Threats** Ploughing**Description**

1983 AP (Musson) showing square, poorly defined cropmark. Sited on flat ground. Nothing visible on ground;

AP plot during project 509 1998. Rectangular cropmark c. 36m NE-SW and 30m NW-SE, with possible entrance along SE side. Nothing visible at time of visit 18/5/98, although farmer recalls seeing circular markings in the field.

References

CCC Site visit form, 1984

CPAT AP, 1983, 83-C-235, 83-10-17 and 18

CPAT Site visit form, 1994

Manley 1990, 47, fig. 2

CPAT Site visit 1998

SMALL ENCLOSURES IN NORTH-EAST WALES
Project 509

Rhwylfa Cropmark. PRN 101729. Scale 1:2,500. Map SJ16SW



Based upon the Ordnance Survey mapping with the permission of the Controller of Her Majesty's Stationary Office
© Crown copyright. Unauthorised reproduction infringes Crown copyright and may lead to prosecution or civil proceedings.
Denbighshire County Council licence number LA09008L. 1998

Archaeological data supplied by The Clwyd-Powys Archaeological Trust from the County Sites and Monuments Record
© CPAT, 1998

MARIAN FFRITH ENCLOSURE**PRN 101730****County** Denbighshire**Community** Cwm**NGR** SJ07477794**Altitude** 229**Period** Prehistoric**Form** Cropmark**Condition** Unknown**Threats** Motorbikes**Description**

1983 AP (Musson) showing ovoid enclosure with possibly associated field systems CAR1816. Bank 0.4m high at best with traces of ditch in places. Sited on gentle E facing slope. Entrance on E side;

Ground survey August 1998. Site measures 105m N-S x 88m E-W, enclosing an area of c. 0.72ha defined by a low bank best preserved to the S where it follows the crest of a limestone ridge. Numerous limestone outcrops within general area, running roughly E-W. The site is currently being used as a course for trail bikes which is leading to some damage to the turf cover.

References

CCC Site visit form 1983,

CCC Site visit form, 1993

CPAT Site visit form 1994

CPAT AP, 1983, 83-10-28 to 29, 83-C-238 and 239, 83-C-260 to 263

CPAT AP, 1984, 84-C-260 and 262, 84-16-21 to 25, 84-16-28 and 29

CPAT AP, 1986, 86-MB-557 and 558

CPAT AP, 1989, 89-MB-351

RCAHMW AP 935102-57 to 59

Manley 1990, 47. fig. 2

CPAT Site visit and ground survey 1998

SMALL ENCLOSURES IN NORTH-EAST WALES
Project 509

Marian Ffrith enclosure. PRN 101730. Scale 1:2,500. Map SJ07NE

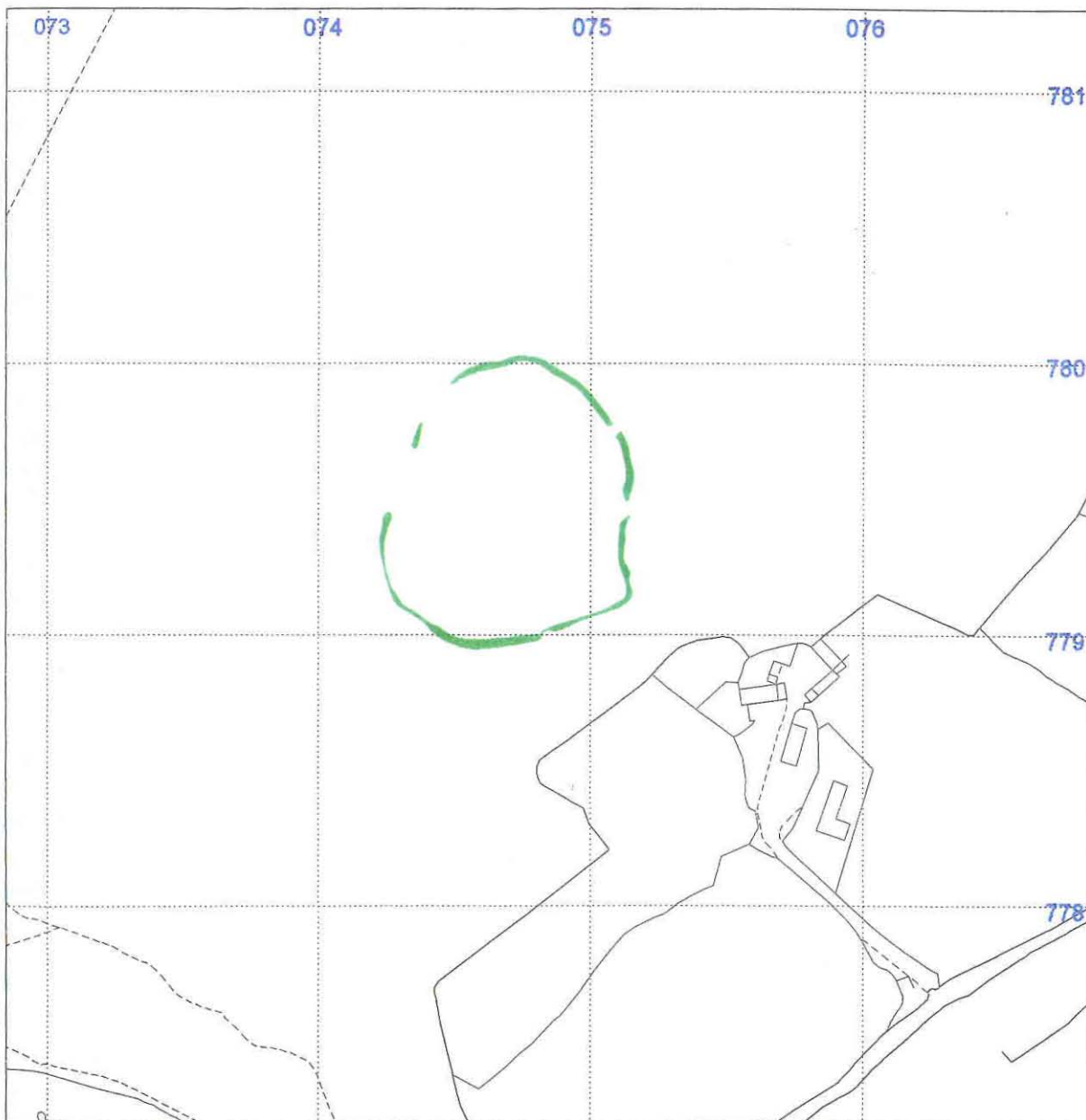

Based upon the Ordnance Survey mapping with the permission of the Controller of Her Majesty's Stationary Office
© Crown copyright. Unauthorised reproduction infringes Crown copyright and may lead to prosecution or civil proceedings.
Denbighshire County Council licence number LA09008L. 1998

Archaeological data supplied by The Clwyd-Powys Archaeological Trust from the County Sites and Monuments Record
© CPAT, 1998

WARREN ENCLOSURE A**PRN 101756**

County	Conwy	Community	Abergele		
NGR	SH96177583	Altitude	175	Period	Prehistoric ?
Form	Earthwork	Condition	Damaged	Threats	None

Description

Two thirds of oval enclosure stands on summit of hill. Bank 0.5m high with external ditch and counterscarp. Possible entrance on N side. Continuation invisible in thicket to east. See also PRN 101757;

Site visit 17/5/98 - Prominent earthwork embankment c. 0.15-0.3m high at E end of field. Enclosure c. 50m diam. with internal area of c. 0.18ha. Embankment diminishes to S, possibly the entrance, and with possible quarry damage. Highest point is to NNW, interior domed with several depressions visible. Features to W may be associated trackways/field boundaries. The SE side has been damaged by small-scale quarrying, mostly along the S side.

References

CCC Site visit form, 1983
CCC ground photo, 1983
CPAT AP, 1989, 89-MB-518
Guilbert, G. 1982, 43 no.55
Manley 1990, 47, fig. 2
CPAT Site visit and ground survey 1998

WARREN ENCLOSURE B**PRN 101757**

County	Conwy	Community	Abergele		
NGR	SH95917582	Altitude	190	Period	Prehistoric ?
Form	Earthwork	Condition	Damaged	Threats	Vehicular access

Description

Ground survey August 1998. Small oval enclosure 35m E-W x 30m N-S, bank up to 0.3m high and 1m wide. Possible entrance to E. Crossed by N-S fence and damaged by quarrying on W side. See also PRN 101756;

Access for farm vehicles along the western side of the fence has led to some damage of the bank and interior. CPAT site visit 1998.

References

CCC Site visit form, 1983
CCC ground photo, 1983
CPAT AP, 1989, 89-MB-521
CUCAP AIW 82
Manley 1990, 47, fig. 2
CPAT Site visit and ground survey 1998

SMALL ENCLOSURES IN NORTH-EAST WALES
Project 509

Warren enclosures A and B, PRNs 101756 and 101757. Scale 1:2,500. Map SH97NE

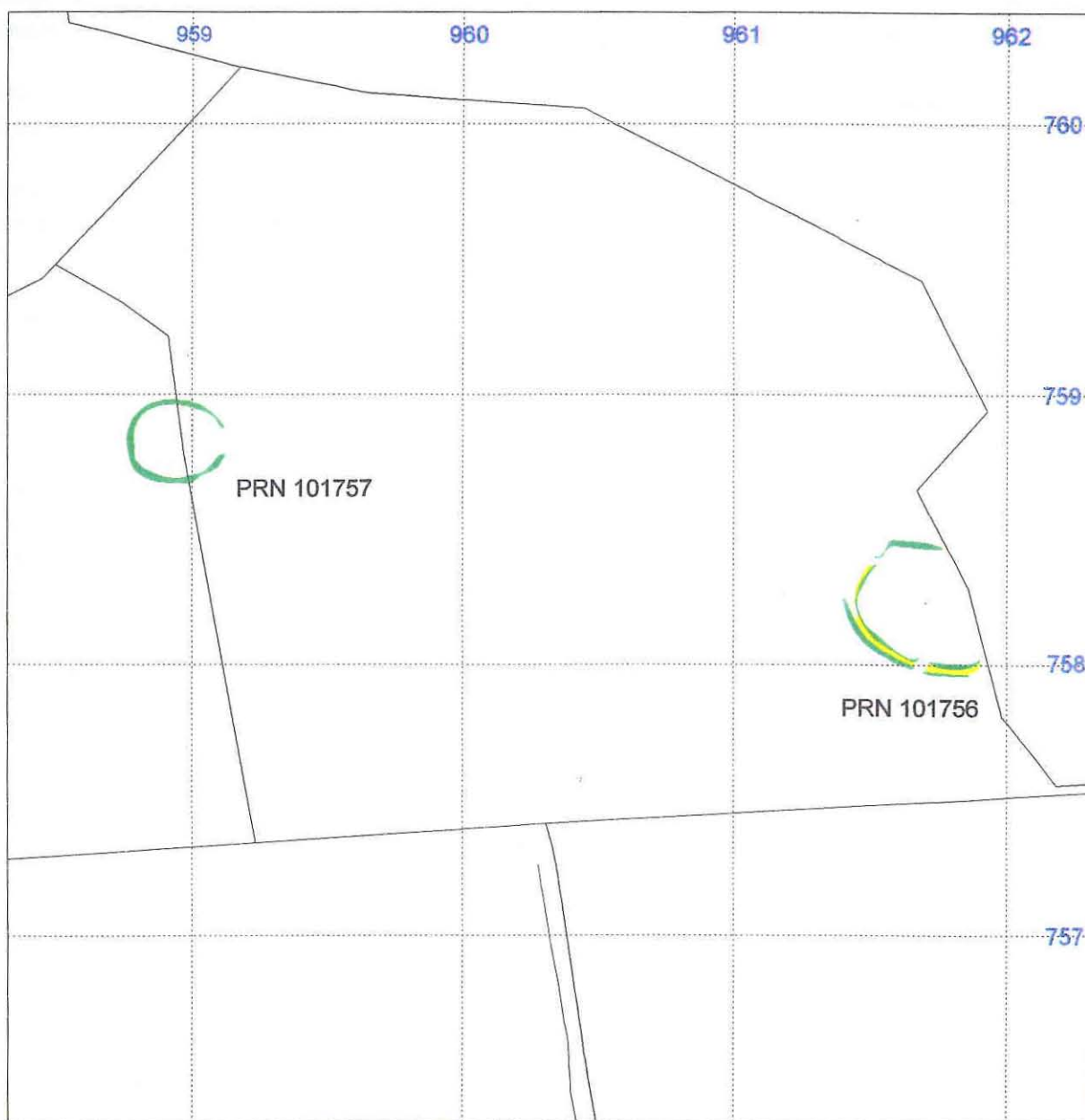

Based upon the Ordnance Survey mapping with the permission of the Controller of Her Majesty's Stationary Office
© Crown copyright. Unauthorised reproduction infringes Crown copyright and may lead to prosecution or civil proceedings.
Conway County Borough Council licence number L09000L 1998

Archaeological data supplied by The Clwyd-Powys Archaeological Trust from the County Sites and Monuments Record
© CPAT, 1998

GWAENYSGOR ENCLOSURE**PRN 101773**

County	Flintshire	Community	Trelawnyd and Gwaenysgor		
NGR	SJ07888154	Altitude	218	Period	Prehistoric ?
Form	Earthwork	Condition	Damaged	Threats	Ploughing

Description

Ploughed down earthwork enclosure noted on 1984 AP (Musson). Oval in shape with no visible entrance. Bisected by hedgeline. Bank to SE is 0.6m high and 1.5m wide. No trace of ditch or entrance. N0884;

Earthwork c. 0.2ha sited on ground that falls gently to south. Overlooked by higher ground to north. Non-defensive position. Possibly associated field system to south (Manley, J 1990b).

Site visit 17/5/98 - Distinct circular embankment c. 1.0-1.5m high. Interior has marked depression giving bowl-like impression. Embankment most prominent at S end near hedge boundary. Site continues into field to W, visible as raised area but detail partly levelled by ploughing.

AP plot during project 509 1998. Diameter c. 50m, internal are 0.16ha.

References

CCC Site visit form, 1984
CCC Site visit form, 1993
CPAT Site visit form, 1994
CPAT AP, 1984, 84-C-269 to 270
CPAT AP, 1986, 86-MB-553
Manley 1990, 48, fig. 2
CPAT Site visit 1998

SMALL ENCLOSURES IN NORTH-EAST WALES
Project 509

Gwaenysgor Enclosure. PRN 101773. Scale 1:2,500. Map SJ08SE

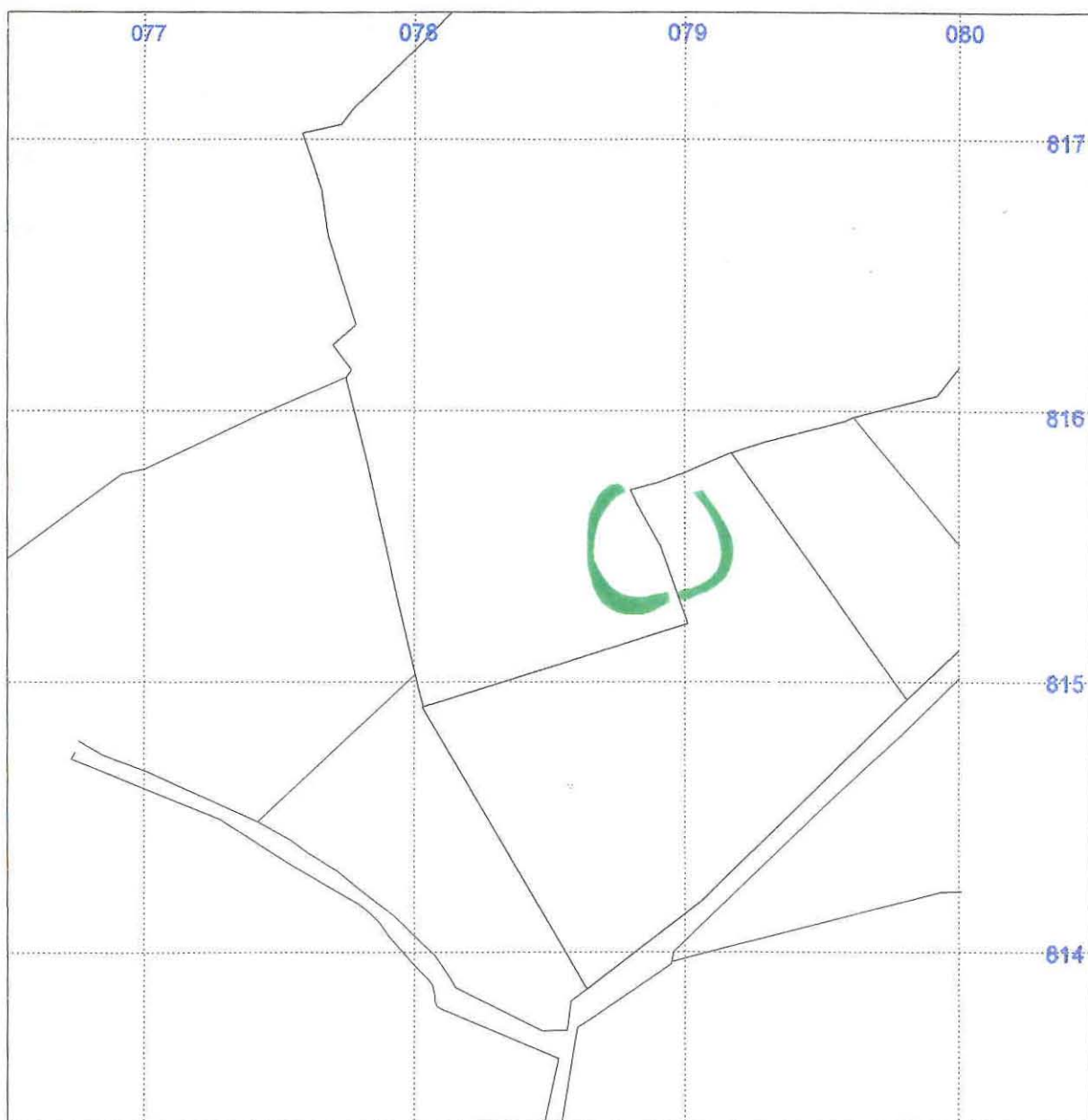

Based upon the Ordnance Survey mapping with the permission of the Controller of Her Majesty's Stationary Office
© Crown copyright. Unauthorised reproduction infringes Crown copyright and may lead to prosecution or civil proceedings.
Denbighshire County Council licence number LA09008L. 1998

Archaeological data supplied by The Clwyd-Powys Archaeological Trust from the County Sites and Monuments Record
© CPAT, 1998

WERN ISAF ENCLOSURE**PRN 101807****County** Denbighshire**Community** Llangollen**NGR** SJ22244233**Altitude** 165**Period** Unknown**Form** Earthwork**Condition** Damaged**Threats** None**Description**

Earthwork enclosure first noted on CPAT AP sited on summit of small hillock with good views all around. Oval in shape. Multivallate on SE side. N1184;

AP plot during project 509 1998. Oval enclosure with interior c. 65m NE-SW and 40m NW-SE, 0.2ha. Earthwork ditch well-defined with slight interior bank. External second ditch to S. Not recognised during site visit 19/5/98 (LB)

References

CCC Site visit form, 1984
CPAT Site visit form, 1994
CPAT AP, 1983, 83-23-32
CPAT AP, 1984, 84-14-33
CPAT AP, 1985, 85-5-16
CPAT AP, 1985, 85-6-29
Manley 1990, 48, fig. 2
CPAT Site visit 1998

SMALL ENCLOSURES IN NORTH-EAST WALES
Project 509

Wern Isaf Enclosure. PRN 101807. Scale 1:2,500. Map SJ24SW

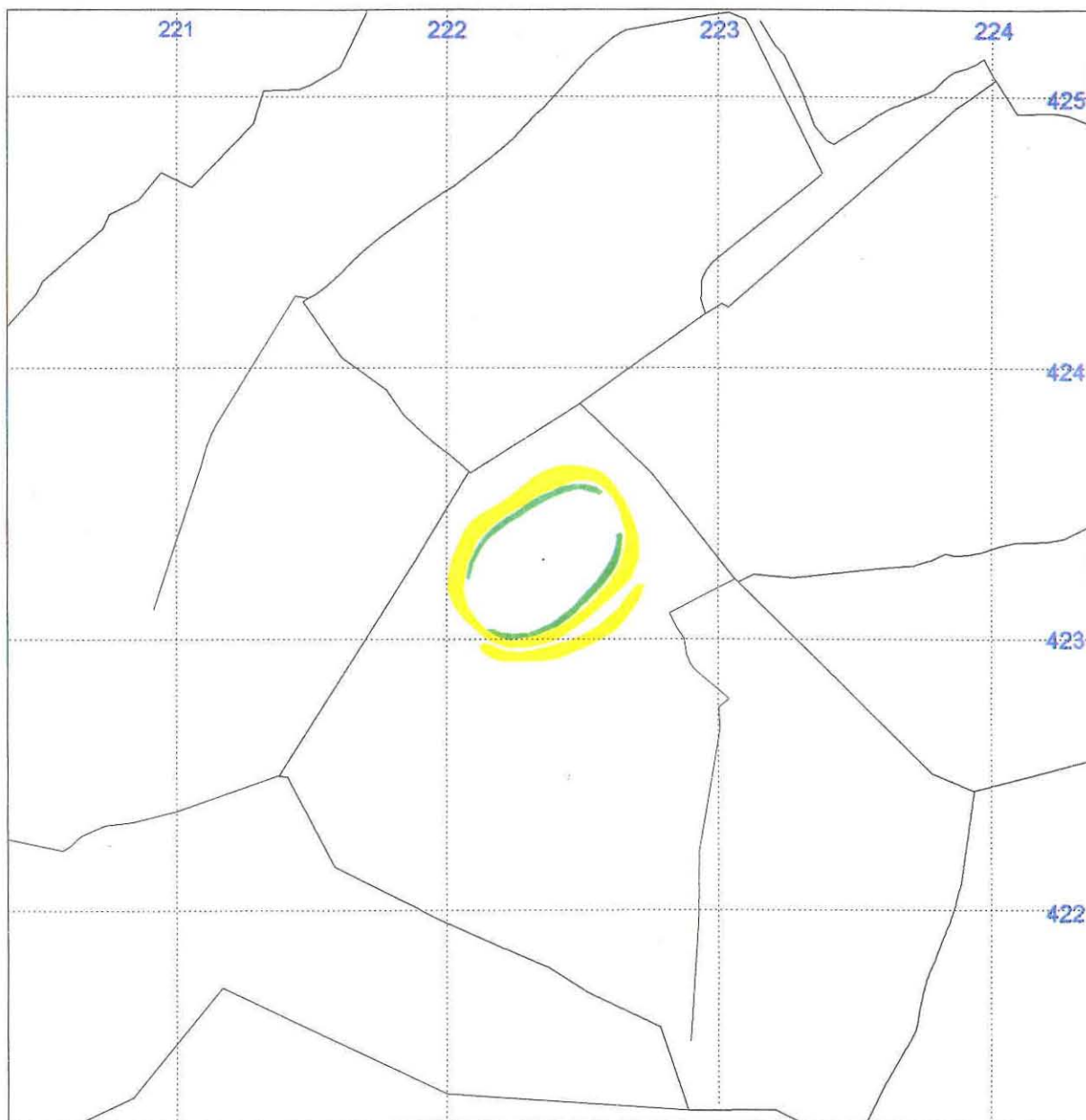

Based upon the Ordnance Survey mapping with the permission of the Controller of Her Majesty's Stationary Office
© Crown copyright. Unauthorised reproduction infringes Crown copyright and may lead to prosecution or civil proceedings.
Denbighshire County Council licence number LA09008L. 1998

Archaeological data supplied by The Clwyd-Powys Archaeological Trust from the County Sites and Monuments Record
© CPAT, 1998

PEN-Y-MYNYDD EARTHWORK**PRN 102156****County** Denbighshire**Community** Tremeirchion**NGR** SJ09527242**Altitude** 182**Period** Prehistoric**Form** Earthwork**Condition** Damaged**Threats****Description**

Oval enclosure marked on the downhill side by a curving bank and ditch. Remainder of circuit is visible on CPAT 86 air photo. Sited on steep west facing slope. U0885;

Site visit 21/10/98. The downslope, SW side is best visible, consisting of a scarp up to 0.75m high with fairly level terrace c. 3m wide max in front. The remainder of the enclosure is much less visible, consisting of a low bank to the NW and a light scarp for the rest of the circuit.

Site is clearly visible on OS vertical from 1974 - 032 74 091

References

Davies, E, 1949, 386-7
OS record card, 1959, SJ07SE 19
CCC visit form, 1982
CCC ground photo, 1983
CCC visit form, 1983
CPAT air photo, 1986, 86-MB-565to567
CPAT air photo, 1988, 88-9-3/4
CPAT sir photo, 1989, 89-MB-550
Manley 1990, 50, fig. 2

SMALL ENCLOSURES IN NORTH-EAST WALES
Project 509

Pen-y-Mynydd earthwork. PRN 102156. Scale 1:2,500. Map SJ07SE



Based upon the Ordnance Survey mapping with the permission of the Controller of Her Majesty's Stationary Office
© Crown copyright. Unauthorised reproduction infringes Crown copyright and may lead to prosecution or civil proceedings.
Denbighshire County Council licence number LA09008L. 1998

Archaeological data supplied by The Clwyd-Powys Archaeological Trust from the County Sites and Monuments Record
© CPAT, 1998

PLASNEWYDD CROPMARK**PRN 102653****County** Denbighshire**Community** Llanfair Dyffryn Clwyd**NGR** SJ13695574**Altitude** 85**Period** Roman**Form** Cropmark**Condition** Unknown**Threats** Ploughing**Description**

Incomplete cropmark of possible Romano-British temple consisting of an inner wide, probably square cropmark, surrounded at a distance by a rectilinear somewhat thinner cropmark. Slight rise visible between marks. U0885;

AP plot during project 509 1998. Inner enclosure defined by ditch c. 5m wide, measuring 18m N-S by 16m E-W internally. E side less well defined, but may include entrance. Outer pair of ditches running parallel, the inner of which is the narrowest. The outermost ditch is clearly visible along most of the W side, part of the S side and possibly part of the N side, giving an overall area of c. 100m N-S x at least 40m E-W.

Site not visible at time of visit 15/5/98.

References

CCC Site visit form, 1978
CCC Site visit form, 1981
CCC Site visit form, 1984
CPAT Site visit form, 1994
CPAT AP, 1983, 83-10-11 to 13
CUCAP CBE 91
Manley 1990, 51, fig. 2
CPAT Site visit 1998

SMALL ENCLOSURES IN NORTH-EAST WALES
Project 509

Plasnewydd Cropmark. PRN 102653. Scale 1:2,500. Map SJ15NW

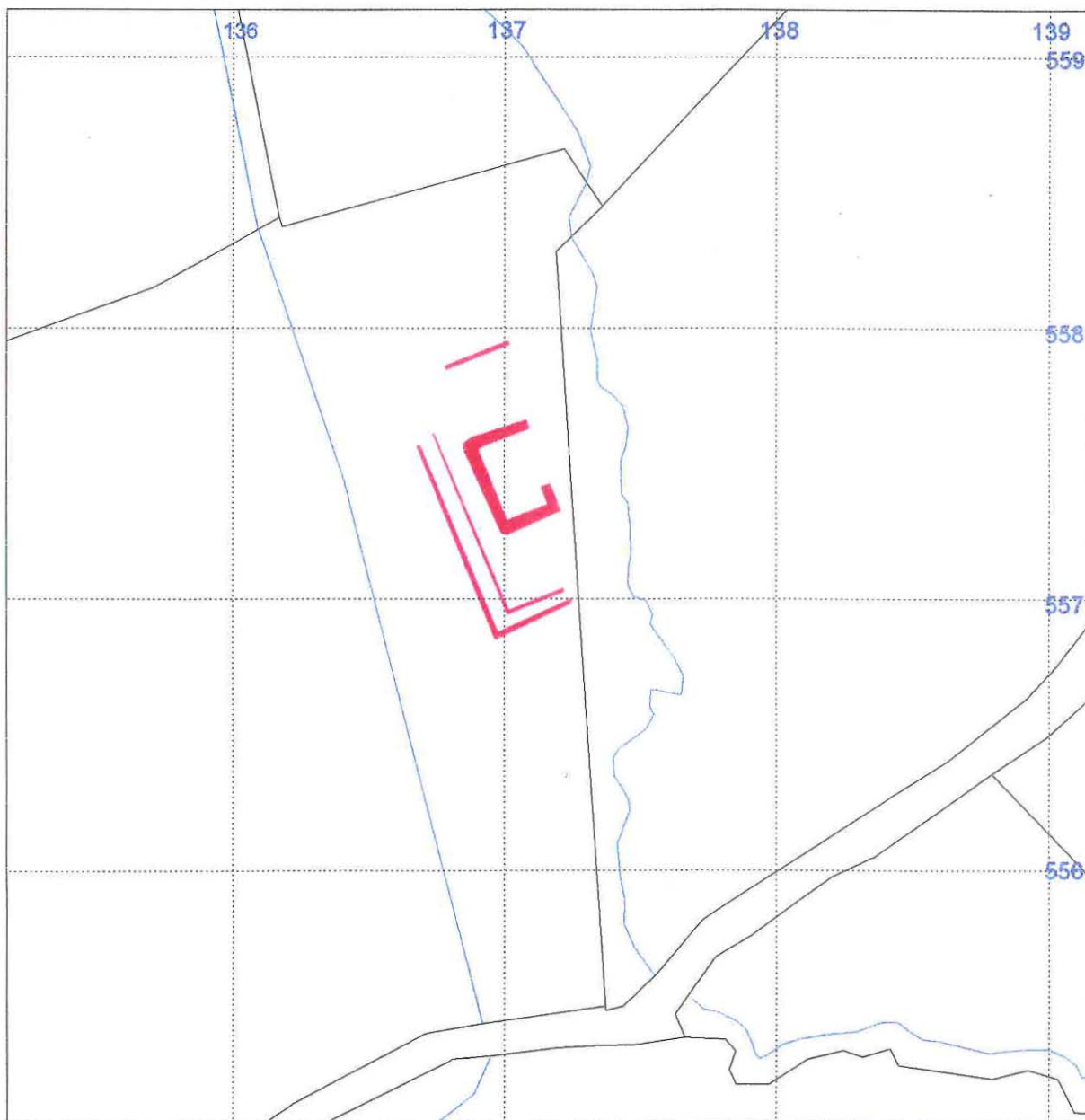

Based upon the Ordnance Survey mapping with the permission of the Controller of Her Majesty's Stationary Office
© Crown copyright. Unauthorised reproduction infringes Crown copyright and may lead to prosecution or civil proceedings.
Denbighshire County Council licence number LA09008L. 1998

Archaeological data supplied by The Clwyd-Powys Archaeological Trust from the County Sites and Monuments Record
© CPAT, 1998

LLANYNYS CROPMARK**PRN 102655****County** Denbighshire**Community** Llanynys**NGR** SJ102626**Altitude** 70**Period** Roman ?**Form** Cropmark**Condition** Unknown**Threats** Ploughing**Description**

Large sub-rectangular cropmark with rounded corners. Situated on flat ground with good views to W. On same photo is the vague outline of what may be a large circular enclosure immediately to the W.1796. U0885;

AP plot during project 509 1998. Overall dimensions c. 100m NE-SW x 50m NW-SE.

Not visible at time of site visit 18/5/98.

References

CUCAP CBE 85

CPAT Site visit form, 1994

Manley 1990, 51, fig. 2

CPAT Site visit 1998

SMALL ENCLOSURES IN NORTH-EAST WALES
Project 509

Llanynys Cropmark. PRN 102655. Scale 1:2,500. Map SJ16SW

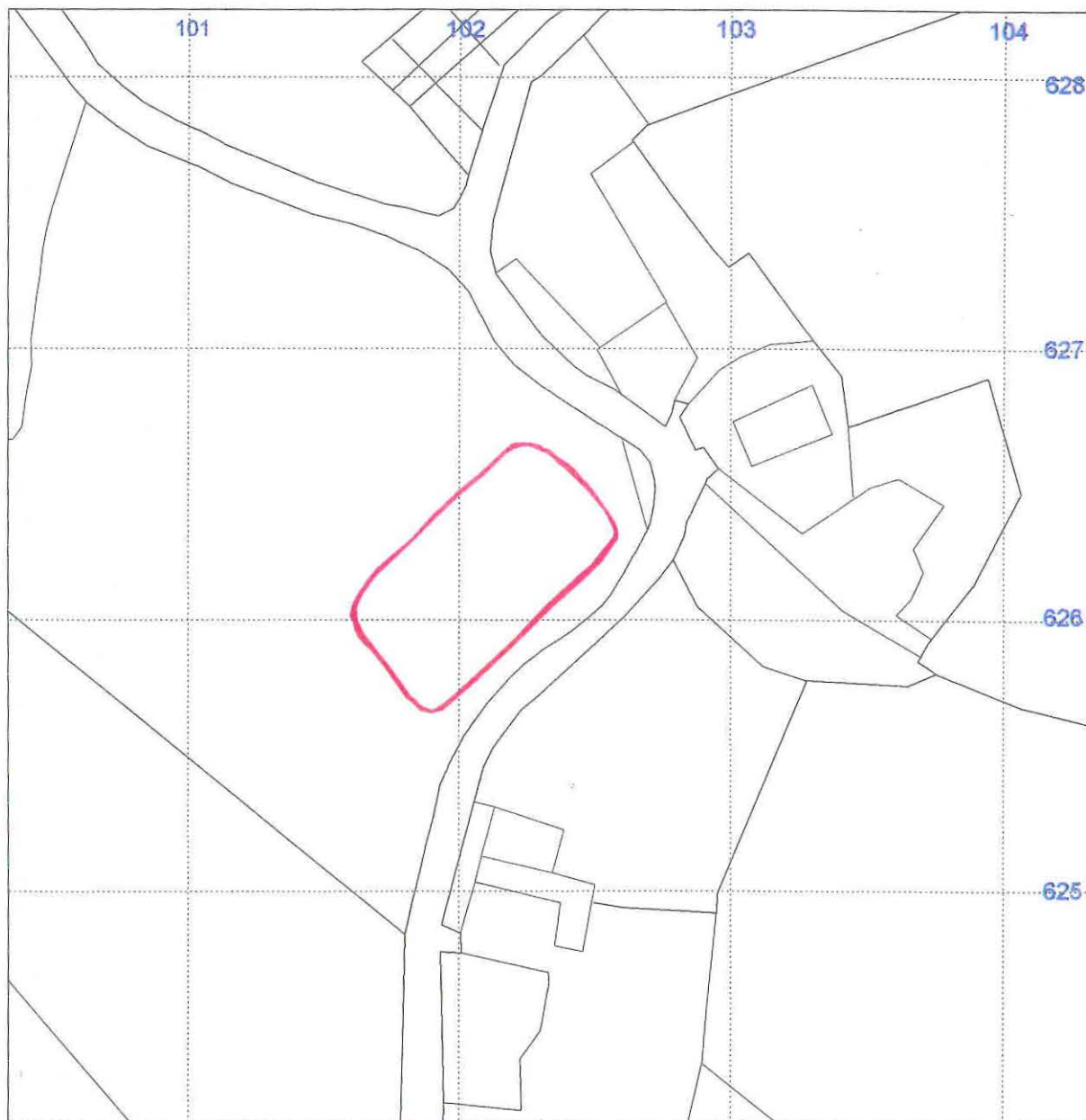

Based upon the Ordnance Survey mapping with the permission of the Controller of Her Majesty's Stationary Office
© Crown copyright. Unauthorised reproduction infringes Crown copyright and may lead to prosecution or civil proceedings.
Denbighshire County Council licence number LA09008L. 1988

Archaeological data supplied by The Clwyd-Powys Archaeological Trust from the County Sites and Monuments Record
© CPAT, 1998

ROYTON ENCLOSURE A**PRN 102658****County** Wrexham**Community** Sesswick**NGR** SJ36984514**Altitude** 30**Period** Prehistoric**Form** Cropmark**Condition** Unknown**Threats** Ploughing**Description**

One of two adjacent sub-rectangular cropmarks with rounded corners, probably related. Possible stock pens. East side not visible. Nothing visible on ground. U0885;

AP plot during project 509 1998. Cropmark defines narrow ditch with straight N side including possible entrance, W side with angular NW corner and rounded SW corner and S side with possible intumed entrance. Not visible beyond N-S boundary to E. Overall max dimensions 62m E-W and 42m N-S, internal area c. 0.23ha.

Nothing visible at time of visit 19/5/98.

References

CCC Site visit form, 1981
CCC Site visit form, 1983
CCC ground photo, 1984
CPAT Site visit form, 1994
Manley 1990, 52, fig. 2
CPAT Site visit 1998

ROYTON ENCLOSURE B**PRN 102659****County** Wrexham**Community** Sesswick**NGR** SJ36974521**Altitude** 30**Period** Prehistoric**Form** Cropmark**Condition** Unknown**Threats** Ploughing**Description**

One of two adjacent sub-rectangular cropmarks. This one has a right angled corner at SW. The other corners are rounded. East side not visible. Nothing visible on ground. U0885;

AP plot during project 509 1998. Sub-square enclosure, N, W and S sides visible with rounded corners except to SW which is more angular. E side not visible due to proximity of field boundary. Internal area c. 0.38ha.

Nothing visible at time of visit 19/5/98.

References

CCC Site visit form, 1981
CCC Site visit form, 1983
CCC ground photo, 1984
CPAT Site visit form, 1994
CPAT AP, 1979, 79-19-27
CPAT AP, 1979, 79-60-8
CPAT AP, 1979, 79-19-29 and 30

CPAT AP, 1979, 79-CT-31 and 34

Manley 1990, 52, fig. 2

CPAT Site visit 1998

SMALL ENCLOSURES IN NORTH-EAST WALES
Project 509

Royton Enclosures A and B. PRNs 102658, 102659. Scale 1:2,500. Map SJ34NE



Based upon the Ordnance Survey mapping with the permission of the Controller of Her Majesty's Stationary Office
© Crown copyright. Unauthorised reproduction infringes Crown copyright and may lead to prosecution or civil proceedings.
Clwyd Powys Archaeological Trust licence number AL 50529A

Archaeological data supplied by The Clwyd-Powys Archaeological Trust from the County Sites and Monuments Record
© CPAT, 1998

GAMFORD HOUSE ENCLOSURE**PRN 102661****County** Wrexham**Community** Rossett**NGR** SJ37765755**Altitude** 13**Period** Prehistoric**Form** Cropmark**Condition** Unknown**Threats** Ploughing**Description**

Cropmark of part of a curvilinear site consisting of at least one and probably two narrow marks. They quite possibly represent palisade trenches and are fairly widely spaced. Possible defended enclosure. U0885;

AP plot during project 509 1998. Poorly defined cropmark enclosure probable consisting of double ditches c. 12m apart. Overall diameter c. 120m, extending into adjacent field to SE, but not visible.

Not visible at time of visit 19/5/98.

References

CCC Site visit form, 1984

CPAT Site visit form, 1994

CPAT AP, 1979, 79-60-13

CPAT AP, 1979, 79-CU-01 and 03

Manley 1990, 52, fig. 2

CPAT Site visit 1998

SMALL ENCLOSURES IN NORTH-EAST WALES
Project 509

Gamford House Enclosure. PRN 102661. Scale 1:2,500. Map SJ35NE

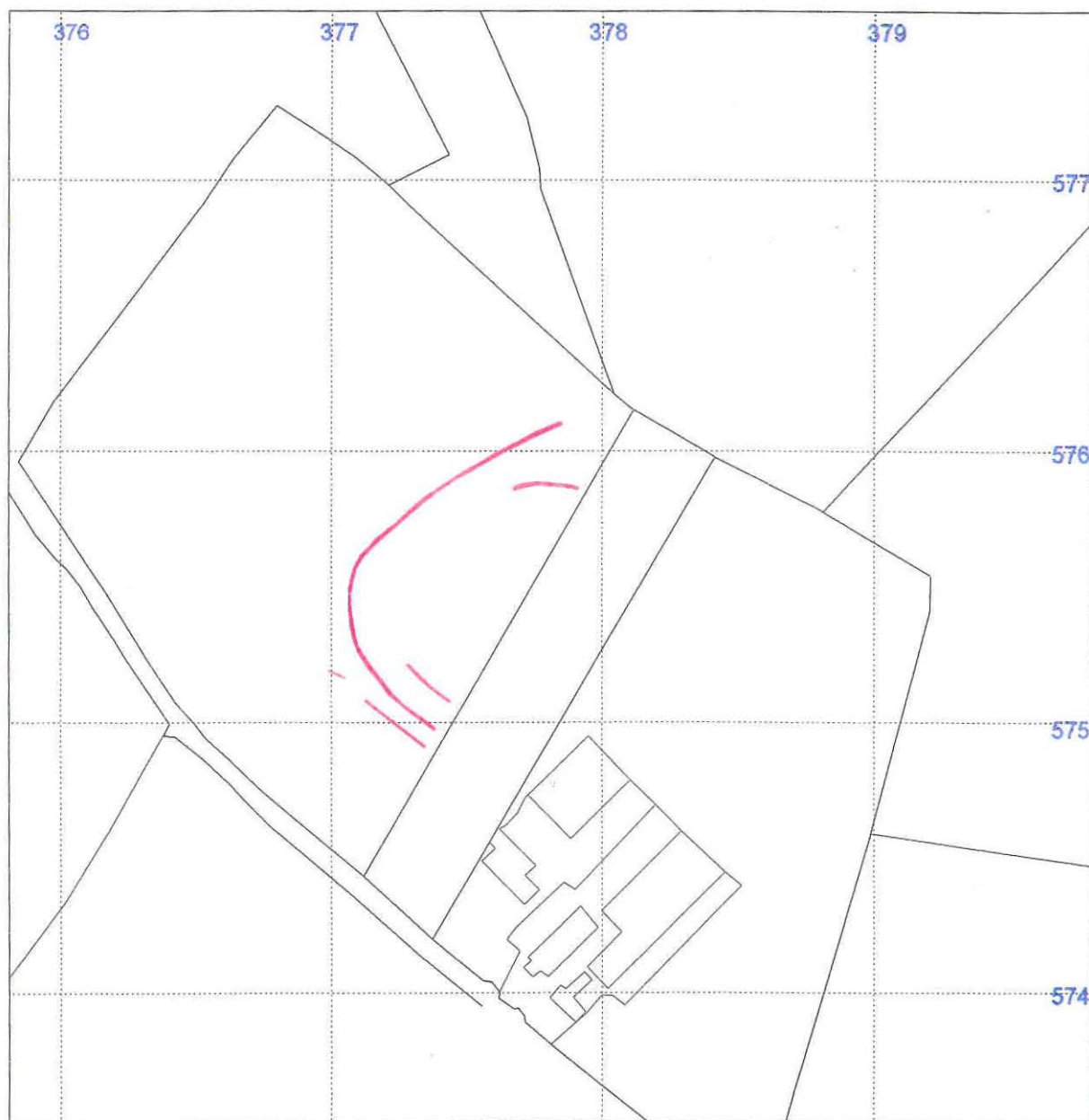

Based upon the Ordnance Survey mapping with the permission of the Controller of Her Majesty's Stationary Office
© Crown copyright. Unauthorised reproduction infringes Crown copyright and may lead to prosecution or civil proceedings.
Redrawn from OS 1:10,000 SJ43SE. Clwyd Powys Archaeological Trust licence number AL 50529A

Archaeological data supplied by The Clwyd-Powys Archaeological Trust from the County Sites and Monuments Record
© CPAT, 1998

FOX HALL ENCLOSURE B**PRN 102742****County** Denbighshire**Community** Henllan**NGR** SJ03336729**Altitude** 162**Period** Prehistoric ?**Form** Earthwork**Condition** Damaged**Threats** None**Description**

Vague earthwork possibly of a sub-rectangular enclosure on a limestone plateau.

Inner turf-covered stone bank raises central area to c1m above the ground level for this area. Disturbed by a holly tree on the west bank and old tree on the east bank. The south-eastern side is not visible, possibly extending into woodland with dense undergrowth. Field slopes away to south, to woodlands and disused quarry. Close proximity to Fox Hall Enclosure PRN 100580 (SAM De 053). (CPAT 1994).

Internal area c. 0.15ha. According to the owner the woodland to the south-east has several old field banks of unknown date which should be visited in winter, once the vegetation has died down (CPAT 1998)

A circular tumulus disturbed by two trees is surrounded by the earthworks of an elongated oval enclosure. Tumuli measures c5m diameter with banks c1.5m high, inner area c2m diameter. Not seen at time of 1998 survey, possibly due to high undergrowth.

References

Davies 1929, 143

CCC ground photo

CCC Site visit form, 1978

CPAT Site visit form, 1994

CPAT Site visit and ground survey 1998

SMALL ENCLOSURES IN NORTH-EAST WALES
Project 509

Fox Hall Enclosure. PRN 102742. Scale 1:2,500. Map SJ06NW

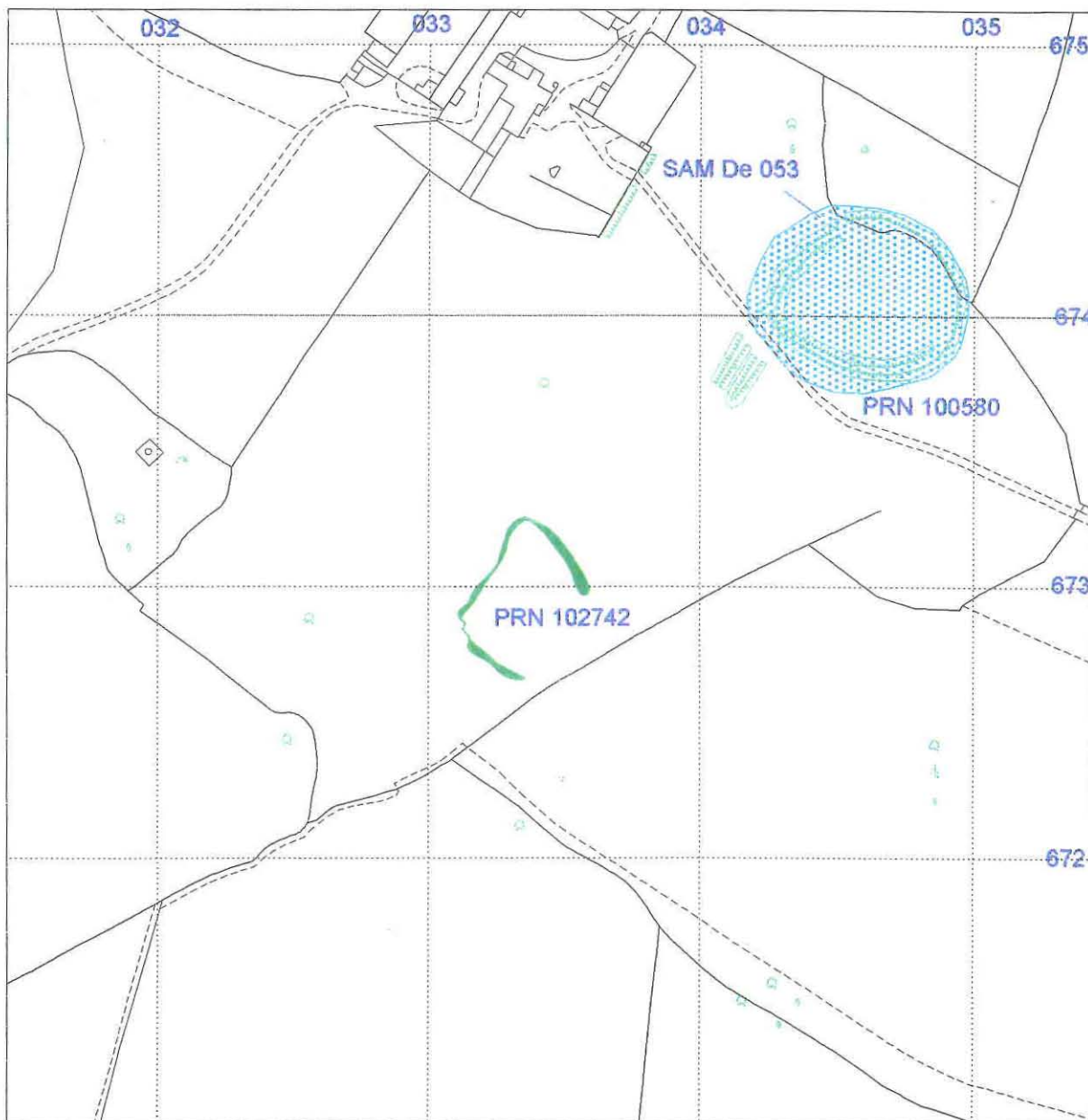

Based upon the Ordnance Survey mapping with the permission of the Controller of Her Majesty's Stationary Office
© Crown copyright. Unauthorised reproduction infringes Crown copyright and may lead to prosecution or civil proceedings.
Denbighshire County Council licence number LA09008L. 1998

Archaeological data supplied by The Clwyd-Powys Archaeological Trust from the County Sites and Monuments Record
© CPAT, 1998

PENNANT CANOL ENCLOSURE**PRN 102934****County** Denbighshire**Community** Llandegla**NGR** SJ17625078**Altitude** 305**Period** Iron Age**Form** Cropmark**Condition** Near destroyed**Threats****Description**

CUCAP showing an ovoid cropmark following the contours of a small knoll. Possible simple entrance visible to NE. Possible ring ditch in W quadrant. Very thin mark palisade. * U0885;

Cropmark c0.38ha, Defensible position (Manley, J 1990b, 52).

Site visit 30/10/98. No evidence of earthworks in pasture field. However, recent quarrying at the southern end of the enclosure has revealed a possible section of the ditch up to 1.75m wide and 0.5m deep, although this is not certain.

References

Wilson, D.R., 1982, F1937

CCC visit form, 1984

Manley 1990, 52, fig. 2

CPAT visit form, 1994

CUCAP CBE 93

SMALL ENCLOSURES IN NORTH-EAST WALES
Project 509

Pennant Canol enclosure. PRN 102934. Scale 1:2,500. Map SJ15SE



Based upon the Ordnance Survey mapping with the permission of the Controller of Her Majesty's Stationary Office
© Crown copyright. Unauthorised reproduction infringes Crown copyright and may lead to prosecution or civil proceedings.
Denbighshire County Council licence number LA09008L. 1998

Archaeological data supplied by The Clwyd-Powys Archaeological Trust from the County Sites and Monuments Record
© CPAT, 1998



Plate 1: Tyddyn Tudor enclosure A PRN 100701 and field system from S. Photo CPAT 87-MB-1012



Plate 2: Wern Isaf enclosure PRN 101807 from NE. Photo CPAT 85-6-29



Plate 3: Caer Drewyn enclosures PRN 101807 and 101810 with field system from N. Photo CUCAP AWP39



Plate 4: Plasnewydd cropmark PRN 102653 from N. CUCAP CBE 91

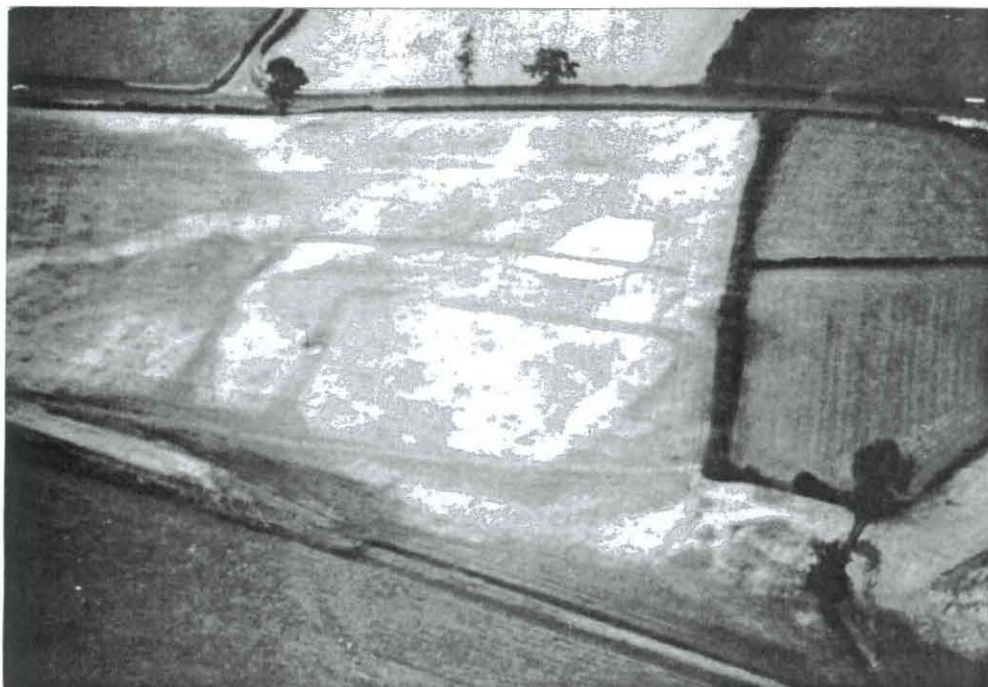

Plate 5: Pentrefelin enclosure PRN 101482 from S. Photo CPAT 79-59-33

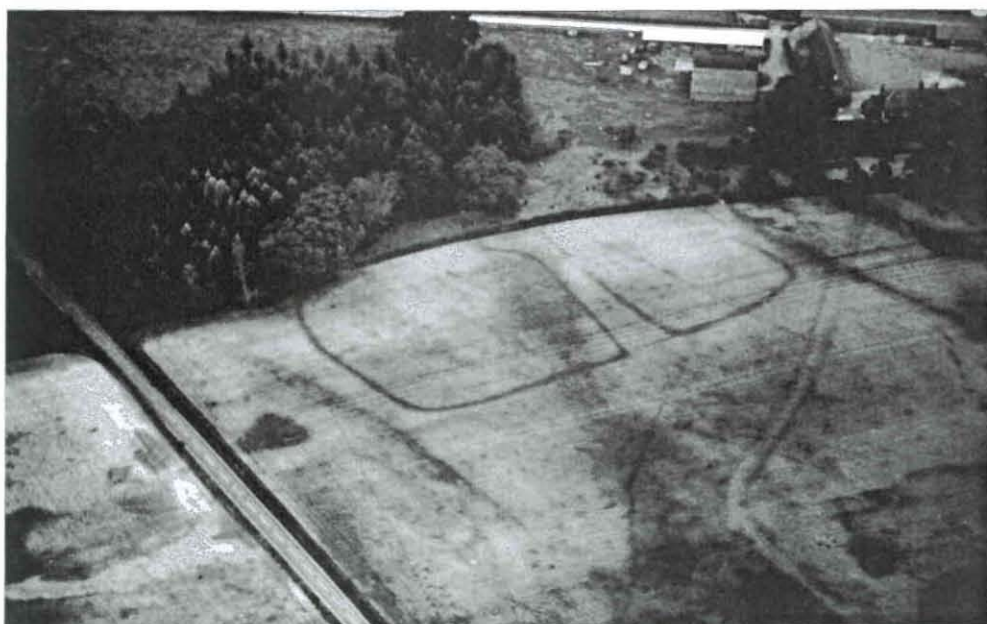

Plate 6: Royton enclosures A and B PRNs 102658-9 from NW. Photo CPAT 79-60-8



Plate 7 Marian Ffrith enclosure PRN 101730 from E. Photo CPAT 84-51-15



Plate 8 Blackhurst enclosures B and C PRNs 101714-5 from SW. Photo CPAT 79-22-3

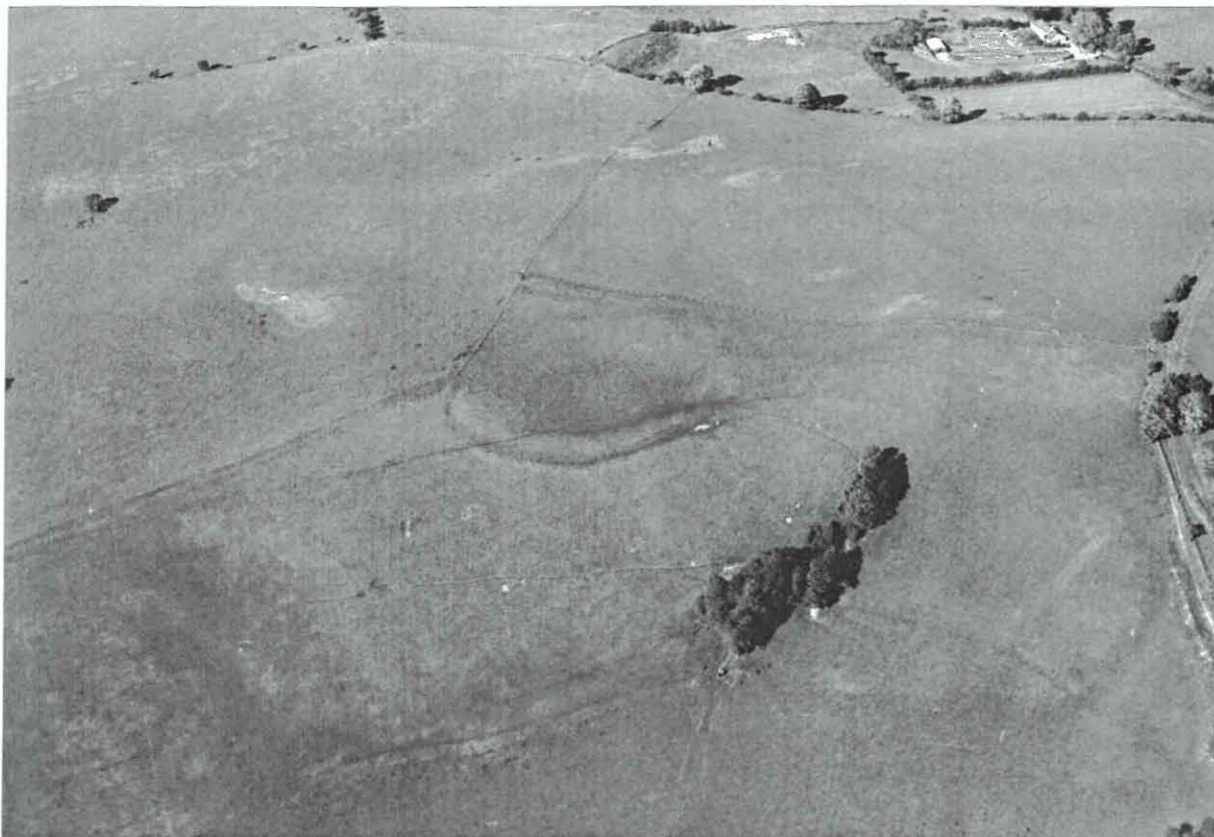

Plate 9 Pen-y-Mynydd enclosure PRN 102156 from SW. Photo CPAT 89-MB-550