

**CPAT Report No 1113**

# Tyrywen, Partrishow, Breconshire

**Archaeological Watching Brief**



**THE CLWYD-POWYS ARCHAEOLOGICAL TRUST**

**CPAT Report No 1113**

**Tyrywen, Partrishow, Breconshire**

**Archaeological Watching Brief**

**N W Jones**  
September 2011

Report for Mr G Brooks

**The Clwyd-Powys Archaeological Trust**

41 Broad Street, Welshpool, Powys, SY21 7RR

tel (01938) 553670, fax (01938) 552179



© CPAT 2011

## CPAT Report Record

### Report and status

CPAT Report Title	Tyrywen, Partrishow, Breconshire: Archaeological Watching Brief		
CPAT Project Name	Tyrywen		
CPAT Project No	1769	CPAT Report No	1113
Confidential (yes/no)	No	draft/final	Final

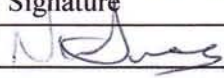
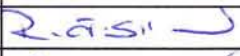
### Internal control

	name	Signature	date
prepared by	N W Jones		02/09/2011
checked by	R.J. Silvester		02/09/2011
approved by	R.J. Silvester		02/09/2011

### Revisions

no	date	made by	checked by	approved by

### Internal memo

## CONTENTS

1	INTRODUCTION
2	WATCHING BRIEF
3	CONCLUSIONS

## 1 INTRODUCTION

- 1.1 The Field Services Section of the Clwyd-Powys Archaeological Trust was invited by Mr M Edwards of McCartneys, acting as agents for Mr G Brooks, to undertake a watching brief during work on a bread oven at Tyrywen, Partrishow, in southern Breconshire (SO 27270 22570). The work was conducted to comply with a request from both Cadw and the Conservation Officer for the Brecon Beacons National Park for an archaeologist to be present during the initial clearance of the oven.
- 1.2 Tyrywen is a grade II listed building (Cadw listing no 20877; PRN 60765) which occupies an isolated position 0.6km west-north-west of Partrishow church, accessed via a track from Llwyn-y-brain. The original dwelling is considered to have been a hall-house built in the 17<sup>th</sup> century, in a position which projects out from the hillside. A wing was added at right angles to the north-east corner during the 18<sup>th</sup> century, and this was extended further in the early 19<sup>th</sup> century. The building is considered to be a good example of a traditional Breconshire farm house which has evolved over several centuries.

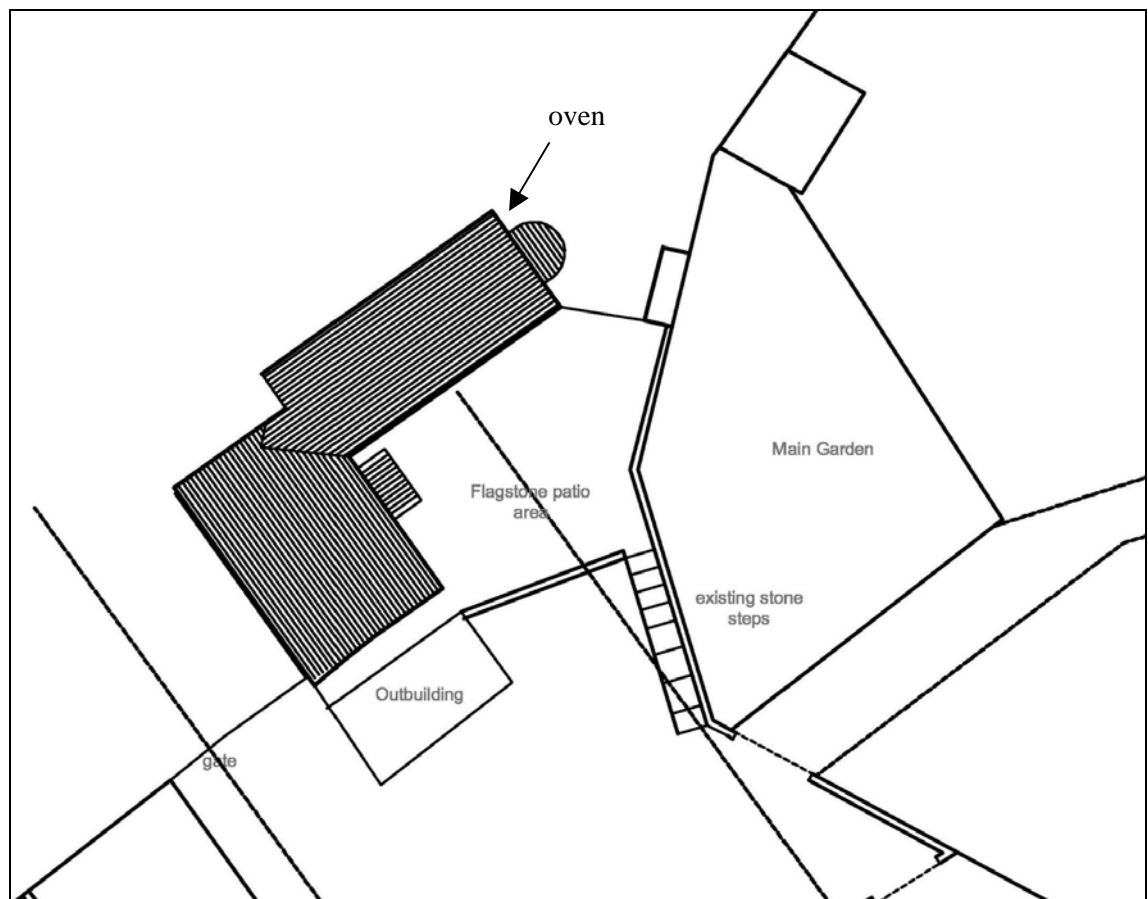

Fig. 1 Plan of Tyrywen showing the location of the bread oven

## 2 WATCHING BRIEF

- 2.1 The watching brief was conducted on 25 August 2011 and monitored the removal by hand of rubble and soil infill within a semi-circular bread oven which projects from the north-east gable of the 19<sup>th</sup>-century extension. After the removal of the infill by contractors the interior was cleaned to enable the archaeological recording of the structure.



Fig. 2 The oven before the removal of the infill

- 2.2 The oven was constructed of random sandstone rubble forming a semi-circular structure 2.75m across and projecting 1.55m from the gable wall. The upper courses were 0.4m thick, while the lower courses were at least 0.7m thick, with facing stones on the exterior only. Inside, the dome of a circular oven was revealed, around 1.0m in diameter and 0.3m high, constructed on lime-mortared fired bricks. The opening in the gable wall was spanned by a substantial timber which showed some signs of movement and repair in the form of packing with stone to provide additional support.
- 2.3 The roof of the oven had been removed prior to the watching brief. This had been constructed of substantial sandstone slabs, the largest of which was 0.85m long and 0.9m wide. Some of the slabs had been shaped and tapered to a curved, sloping roof which was supported on the retaining wall of the oven, together with the rubble infill, without the need for any timber. The stones had been removed carefully and numbered to allow an accurate reconstruction. A stone drip course projects from the gable wall above the roof-line of the oven.
- 2.4 To the right of the oven a blocked window opening was noted, measuring 0.4m high and 0.22m wide.



Fig. 2 The structure following the removal of infill, with the domed oven visible inside

### 3 CONCLUSIONS

- 3.1 The watching brief has provided a photographic and written record of a 19<sup>th</sup>-century bread oven attached to the north-eastern gable wall of Tyrywen, Partrishow, a grade II listed building. Ovens of this type were once a common feature of farmhouses not only in Breconshire, but across Wales as a whole.
- 3.2 The site archive has been deposited with the regional Historic Environment Record, maintained by the Clwyd-Powys Archaeological Trust in Welshpool.